

| Ref # | Part Number | Qty | Description                                   |
|-------|-------------|-----|---|
| 1     | 31411A      | 0   | Cylinder Assy. (2-1/2" Bore)                  |
| 2     | 27652       | 0   | Pin, Dowel                                    |
| 3A    | 27642       | 0   | Plug, Drain                                   |
| 3     | 27642       | 0   | Plug, Drain                                   |
| 4     | 27876B      | 0   | Seal, Oil                                     |
| 5     | 27877A      | 0   | Valve, Intake (Standard)                      |
| 5     | 27879A      | 0   | Valve, Intake (1/32" Oversize)                |
| 6     | 27878A      | 0   | Valve, Intake (Standard)                      |
| 6     | 27880A      | 0   | Valve, Intake (1/32" oversize)                |
| 7     | 27882       | 0   | Cap, Upper valve spring                       |
| 8     | 27881       | 0   | Spring, Valve                                 |
| 9A    | 27883       | 0   | Cap, Lower valve spring (Standard)            |
| 9A    | 30964       | 0   | Cap, Lower valve spring (1/32" oversize)      |
| 9     | 27883       | 0   | Cap, Lower valve spring (Standard)            |
| 9     | 30964       | 0   | Cap, Lower valve spring (1/32" oversize)      |
| 10    | 20810       | 0   | Pin, Valve spring retaining                   |
| 11    | 31826       | 0   | Crankshaft Assy.                              |
| 12    | 29783       | 0   | Pin, Crankshaft gear                          |
| 13    | 27884       | 0   | Gear, Crankshaft                              |
| 14    | 27886       | 0   | Piston & Pin Assy. (.010 Oversize)            |
| 14    | 27887       | 0   | Piston & Pin Assy. (.020 Oversize)            |
| 14    | 28739       | 0   | Piston & Pin Assy. (Standard) (2-1/2")        |
| 15    | 27889       | 0   | Ring Set, Piston (Std.) (2-1/2")              |
| 15    | 27890       | 0   | Ring Set, Piston (.010 oversize)              |
| 15    | 27891       | 0   | Ring Set, Piston (.020 oversize)              |
| 15    | 29907       | 0   | Re-Ringing Set, Piston                        |
| 16    | 27888       | 0   | Ring, Piston pin retaining                    |
| 17    | 31295B      | 0   | Rod Assy., Connecting                         |
| 18    | 21718       | 0   | Bolt, Connecting rod                          |
| 19    | 26073       | 0   | Washer, Connecting rod bolt                   |
| 20    | 28264       | 0   | Nut   |
| 21    | 31296       | 0   | Camshaft (No compression release)             |
| 22    | 27893       | 0   | Lifter, Valve                                 |
| 23    | 32523       | 0   | Cover, Cylinder                               |
| 24    | 28460       | 0   | Seal, Oil                                     |
| 25    | 30924A      | 0   | Dipstick Oil                                  |
| 26    | 30684       | 0   | Gasket, Mounting flange                       |
| 27    | 8303        | 0   | Lockwasher                                    |
| 28    | 30564       | 0   | Screw   |
| 28    | 650488      | 0   | Screw   |
| 30    | 29673       | 0   | Gasket, Filler plug                           |
| 31    | 650489      | 0   | Screw   |
| 32    | 28938B      | 0   | Gasket, Cylinder head                         |
| 33    | 30938A      | 0   | Head, Cylinder                                |
| 34    | 27793       | 0   | Clip, Conduit                                 |
| 35    | 28942       | 0   | Screw   |
| 36    | 650694      | 0   | Screw, Hex hd. cap, 5/16-18 x 2               |
| 36    | 650695      | 0   | Screw, Hex hd. cap, 5/16-18 x 2-1/4 (Grade 8) |
| 36    | 650697      | 0   | Screw, Hex hd. cap, 5/16-18 x 2-1/2           |
| 37    | 33636       | 0   | Plug, Spark (Champion J-8 or equivalent)      |
| 38    | 27896       | 0   | Gasket, Breather cover                        |
| 39    | 28423       | 0   | Body, Breather                                |
| 40    | 28424       | 0   | Element, Breather                             |
| 41    | 28425       | 0   | Cover, Valve chamber                          |
| 42    | 26073       | 0   | Washer, Connecting rod bolt                   |

| Ref # | Part Number | Qty | Description                             |
|-------|-------------|-----|---|
| 43A   | 8269        | 0   | Washer                                  |
| 43    | 650128      | 0   | Screw                                   |
| 43    | 650597      | 0   | Screw, Hex washer hd., 10-24 x 5/8      |
| 44    | 27627       | 0   | Tube, Breather                          |
| 45    | 27915       | 0   | Gasket, Intake pipe                     |
| 46    | 30195A      | 0   | Flange, Carburetor                      |
| 48    | 30196       | 0   | Screw                                   |
| 50    | 650548      | 0   | Screw, Hex washer hd., 8-32 x 5/16      |
| 51    | 30319       | 0   | Rivet, Split                            |
| 52    | 31709       | 0   | Lever, Governor                         |
| 54    | 28819       | 0   | Spring, Fuel line                       |
| 54    | 31778       | 0   | Spring, Coil                            |
| 55    | 30205       | 0   | Bracket, Adjusting                      |
| 56    | 30206       | 0   | Link, Throttle                          |
| 57    | 30985       | 0   | Control, Throttle                       |
| 57A   | 24522       | 0   | Control, Throttle                       |
| 58    | 31879       | 0   | Link, Governor lever to bellcrank       |
| 59    | 29216       | 0   | Nut                                     |
| 60    | 650152      | 0   | Screw                                   |
| 61    | 29826       | 0   | Screw                                   |
| 62    | 29642       | 0   | Ring, Retaining                         |
| 63    | 30699A      | 0   | Rod Assy., Governor                     |
| 64    | 29536       | 0   | Baffle, Blower housing                  |
| 65    | 650561      | 0   | Screw                                   |
| 66    | 30592       | 0   | Decal, Instruction                      |
| 67    | 650399      | 0   | Screw, Phil. fil. hd. Sems, 10-32 x 5/8 |
| 68    | 8274        | 0   | Lockwasher                              |
| 69    | 29747A      | 0   | Screw                                   |
| 70    | 32158B      | 0   | Housing, (5.56 Dia. starter mtg. bolt   |
| 71    | 650490      | 0   | Washer, Belleville                      |
| 72    | 8116        | 0   | Nut                                     |
| 73    | 30700       | 0   | Yoke, Governor                          |
| 74    | 650494      | 0   | Screw                                   |
| 75    | 31688       | 0   | Gasket, Carburetor (1/8 thick)          |
| 77    | 31345       | 0   | Plate, Identification                   |
| 78    | 29309       | 0   | Stud, Drive                             |
| 79    | 29752       | 0   | Nut                                     |
| 80    | 650572      | 0   | Screw                                   |
| 83    | 27272       | 0   | Gasket, Air cleaner                     |
| 87    | 31691       | 0   | Bracket, Air cleaner                    |
| 88    | 650399      | 0   | Screw, Phil. fil. hd. Sems, 10-32 x 5/8 |
| 88    | 650521      | 0   | Screw                                   |
| 88    | 28820       | 0   | Screw                                   |
| 89    | 30727       | 0   | Element, Air cleaner                    |
| 90A   | 31715       | 0   | Body, Air cleaner                       |
| 91    | 30312       | 0   | Screw, Hex washer hd. Sems, 10-32 x 1/2 |
| 92    | 30712       | 0   | Lever, Bellcrank                        |
| 93    | 29530       | 0   | Bushing, Lever                          |
| 93A   | 28562       | 0   | Bushing, Lever                          |
| 94    | 30202       | 0   | Spring, Extension                       |
| 95    | 30201A      | 0   | Lever, Speed control                    |
| 96    | 30199A      | 0   | Bracket, Speed control                  |
| 98    | 28569       | 0   | Spring, Compression                     |
| 98    | 32924       | 0   | Spring, Compression                     |
| 99    | 29500       | 0   | Screw, Fil. hd. mach., Sems, 8-32 x 3/4 |

| Ref # | Part Number | Qty | Description                                 |
|-------|-------------|-----|---|
| 99    | 650223      | 0   | Screw, Fil. slotted hd. Sems, 8-32 x 5/8    |
| 99    | 650688      | 0   | Screw, Hex hd., 10-32 x 1-5/16" (Drilled    |
| 100   | 29538       | 0   | Base, Mounting                              |
| 102   | 650561      | 0   | Screw                                       |
| 105   | 31793       | 0   | Bearing, Ball                               |
| 106   | 31845       | 0   | Shaft, Mechanical governor                  |
| 108   | 29193       | 0   | Ring, Retaining                             |
| 109   | 30588A      | 0   | Spool, Governor                             |
| 111   | 31300       | 0   | Bracket, Fuel tank                          |
| 113   | 30688       | 0   | Screw, Hex hd. Sems, 1/4-20 x 1/2           |
| 113   | 650561      | 0   | Screw                                       |
| 114   | 31321       | 0   | Tank Assy., Fuel (2 qt.)                    |
| 115   | 32387A      | 0   | Cap, Fuel filler (Charcoal Plastic) (Spurt  |
| 115   | 33032       | 0   | Cap, Fuel filler (Red Plastic) (Spurt       |
| 115A  | 30998B      | 0   | Cap, Fuel filler (Red Plastic) (Sno Proof)  |
| 117   | 28584       | 0   | Strainer & Elbow                            |
| 118   | 29774       | 0   | Line, Fuel (Braided 8.25")                  |
| 118   | 30705       | 0   | Line, Fuel (Braided 16")                    |
| 118   | 30962       | 0   | Line, Fuel (Braided 32")                    |
| 119   | 31792       | 0   | Washer, Thrust                              |
| 120   | 30688       | 0   | Screw, Hex hd. Sems, 1/4-20 x 1/2           |
| 120   | 650128      | 0   | Screw                                       |
| 121   | 30622       | 0   | Extension, Blower housing                   |
| 125   | 27930       | 0   | Gasket, Exhaust                             |
| 126   | 650178      | 0   | Screw                                       |
| 127   | 26073       | 0   | Washer, Connecting rod bolt                 |
| 128   | 30196       | 0   | Screw                                       |
| 128   | 650694      | 0   | Screw, Hex hd. cap, 5/16-18 x 2             |
| 129   | 30884       | 0   | Key, Flywheel                               |
| 130   | 31843A      | 0   | Bracket, Governor                           |
| 131   | 28763       | 0   | Screw, Hex washer hd. thread-forming, 10-24 |
| 132   | 30091       | 0   | Screw, Hex slotted washer hd., 8-32 x 1/2   |
| 132   | 650548      | 0   | Screw, Hex washer hd., 8-32 x 5/16          |
| 133   | 650493      | 0   | Screw, Hex hd. Sems, 1/4-20 x 1-3/4         |
| 144   | 650542      | 0   | Screw, Hex hd. cap, 5/16 18 x 13/16         |
| 145   | 31752       | 0   | Decal, Air cleaner                          |
| 148   | 30529       | 0   | Nut, Lock                                   |
| 149   | 30747       | 0   | Clip, Shorting                              |
| 149   | 31861       | 0   | Clip, Shorting                              |
| 150   | 16645       | 0   | Lockwasher                                  |
| 151   | 30066       | 0   | Screw                                       |
| 152   | 30063       | 0   | Screw                                       |
| 152   | 30688       | 0   | Screw, Hex hd. Sems, 1/4-20 x 1/2           |
| 153   | 30064       | 0   | Cover, Rectifier panel                      |
| 154   | 30065       | 0   | Nut, Long 5-40                              |
| 155   | 31324       | 0   | Decal, Name & H.P., (6 H.P.)                |
| 155   | 31325       | 0   | Decal, Name & H.P. (5 H.P.)                 |
| 155   | 31328       | 0   | Decal, Name & H.P., (4 H.P.)                |
| 156   | 28728       | 0   | Nut   |
| 157   | 28727       | 0   | Lockwasher                                  |
| 159   | 28726       | 0   | Screw, Phil. rd. hd., 5-40 x 9/16           |
| 160   | 30595       | 0   | Decal, Ezee-start                           |
| 162   | 29918       | 0   | Lockwasher                                  |
| 164   | 30322       | 0   | Nut & Lockwasher                            |
| 165   | 29916       | 0   | Clamp, Governor lever                       |

| Ref # | Part Number | Qty | Description                       |
|-------|-------------|-----|-----------------------------------|
| 176   | 30972       | 0   | Bracket, Choke control            |
| 177   | 29774       | 0   | Line, Fuel (Braided 8.25")        |
| 182   | 30063       | 0   | Screw                             |
| 182   | 30688       | 0   | Screw, Hex hd. Sems, 1/4-20 x 1/2 |
| 184   | 29521       | 0   | Pin, Dowel                        |
| 194   | 31478       | 0   | Decal, H.P. (4 H.P.)              |
| 194   | 31517       | 0   | Decal, H.P. (5 H.P.)              |
| 194   | 32173       | 0   | Decal, H.P. (6 H.P.)              |
| 206   | 30590A      | 0   | Washer, Flat                      |
| 209   | 30939       | 0   | Cover, Cylinder head              |
| 232   | 31548       | 0   | Knob, Seed control                |
| 232   | 32410       | 0   | Knob, Speed control               |
| 238   | 650489      | 0   | Screw                             |
| 253   | 30767       | 0   | Spacer, Air cleaner               |
| 258   | 31298       | 0   | Strip, Dampener                   |
| 259   | 31299       | 0   | Brace, Tank mounting              |
| 260   | 29752       | 0   | Nut                               |
| 260   | 650116      | 0   | Nut, Lock                         |
| 260   | 650456      | 0   | Nut, Lock                         |
| 261   | 650168      | 0   | Washer, Flat                      |
| 262   | 29716       | 0   | Screw                             |
| 264A  | 590417      | 0   | Screen, Starter cup               |
| 264   | 32125       | 0   | Cup, Starter                      |
| 266   | 26460       | 0   | Clamp, Fuel line                  |
| 267   | 33356       | 0   | Terminal, Ground                  |
| 268   | 31584       | 0   | Cup, Spark plug                   |
| 269   | 31583       | 0   | Clamp, Wire                       |
| 270   | 31461       | 0   | Bushing, Crankshaft               |
| 271   | 31546       | 0   | Bushing, Crankshaft               |
| 272   | 31660       | 0   | Cover, Fuel pump pad              |
| 277   | 29212       | 0   | Screw                             |
| 277   | 650451      | 0   | Screw                             |
| 278   | 6202        | 0   | Screw                             |
| 286   | 27275       | 0   | Clip, Hi-tension wire             |
| 286   | 29443       | 0   | Clip, Fuel line                   |
| 289   | 730512      | 0   | Kit, Pre-cleaner                  |
| 290   | 31667       | 0   | Spring, Pre-cleaner bag           |
| 291   | 31668       | 0   | Bag, Pre-cleaner                  |
| 296   | 28942       | 0   | Screw                             |
| 296   | 650229      | 0   | Screw                             |
| 296A  | 650147      | 0   | Washer, Flat                      |
| 305   | 30547A      | 0   | Contact Assy., Breaker            |
| 306   | 30548A      | 0   | Condenser                         |
| 307   | 631021      | 0   | Inlet Needle, Seat & Clip Assy.   |
| 309   | 31855       | 0   | Retainer, Bearing                 |
| 310   | 27183       | 0   | Washer, Fiber                     |
| 311   | 650580      | 0   | Nut, Lock                         |
| 316   | 32203       | 0   | Cleaner, Starter air              |
| 317   | 32204       | 0   | Bracket, Starter air cleaner      |
| 318   | 650583      | 0   | Washer, Flat                      |
| 328   | 730127      | 0   | Cleaner Assy., Air (Poly)         |
| 334   | 32179       | 0   | Decal, Super-start                |
| 335   | 32130       | 0   | Decal, Long Life                  |
| 352   | 8274        | 0   | Lockwasher                        |
| 360   | 631063A     | 0   | Carburetor                        |

| Ref # | Part Number | Qty | Description              |
|-------|-------------|-----|--------------------------|
| 361A  | 33018       | 0   | Harness, Adapter         |
| 361   | 610689A     | 0   | Magneto, Tecumseh        |
| 362   | 590420      | 0   | Starter, Rewind          |
| 363   | 29965       | 0   | Motor, Starter (12 Volt) |
| 363   | 32468       | 0   | Motor, Starter (12 Volt) |
| 363   | 32468A      | 0   | Motor, Starter (12 Volt) |
| 363   | 32468B      | 0   | Motor, Starter (12 Volt) |
| 364   | 33235       | 0   | Gasket Set               |

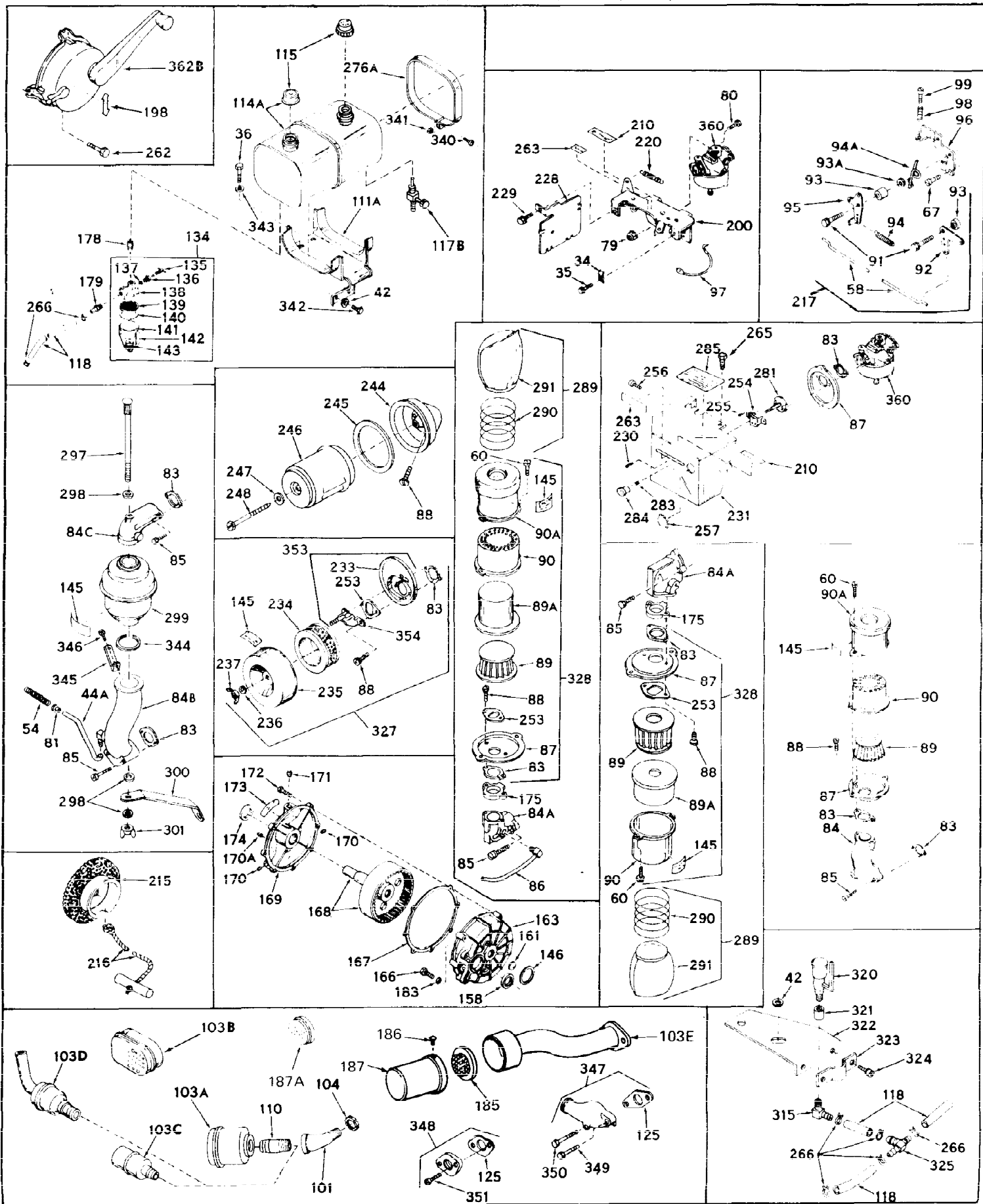

| Ref # | Part Number | Qty | Description                                  |
|-------|-------------|-----|--|
| 34    | 27793       | 0   | Clip, Conduit                                |
| 35    | 28942       | 0   | Screw  |
| 36    | 650694      | 0   | Screw, Hex hd. cap, 5/16-18 x 2              |
| 36    | 650695      | 0   | Screw, Hex hd. cap, 5/16-18 x 2-1/4 (Grade 8 |
| 36    | 650697      | 0   | Screw, Hex hd. cap, 5/16-18 x 2-1/2          |
| 42    | 26073       | 0   | Washer, Connecting rod bolt                  |
| 54    | 28819       | 0   | Spring, Fuel line                            |
| 54    | 31778       | 0   | Spring, Coil                                 |
| 58    | 31879       | 0   | Link, Governor lever to bellcrank            |
| 60    | 650152      | 0   | Screw  |
| 67    | 650399      | 0   | Screw, Phil. fil. hd. Sems, 10-32 x 5/8      |
| 79    | 29752       | 0   | Nut  |
| 80    | 650572      | 0   | Screw  |
| 83    | 27272       | 0   | Gasket, Air cleaner                          |
| 85    | 29786       | 0   | Screw  |
| 85    | 650163      | 0   | Screw, Fil. hd. Sems, 10-32 x 7/8            |
| 85    | 650416      | 0   | Screw, Rd. hd. Sems, 10-32 x 1               |
| 85    | 650605      | 0   | Screw  |
| 87    | 31691       | 0   | Bracket, Air cleaner                         |
| 88    | 650399      | 0   | Screw, Phil. fil. hd. Sems, 10-32 x 5/8      |
| 88    | 650521      | 0   | Screw  |
| 88    | 28820       | 0   | Screw  |
| 89    | 30727       | 0   | Element, Air cleaner                         |
| 90A   | 31715       | 0   | Body, Air cleaner                            |
| 91    | 30312       | 0   | Screw, Hex washer hd. Sems, 10-32 x 1/2      |
| 92    | 30712       | 0   | Lever, Bellcrank                             |
| 93    | 29530       | 0   | Bushing, Lever                               |
| 93A   | 28562       | 0   | Bushing, Lever                               |
| 94    | 30202       | 0   | Spring, Extension                            |
| 95    | 30201A      | 0   | Lever, Speed control                         |
| 96    | 30199A      | 0   | Bracket, Speed control                       |
| 98    | 28569       | 0   | Spring, Compression                          |
| 98    | 32924       | 0   | Spring, Compression                          |
| 99    | 29500       | 0   | Screw, Fil. hd. mach., Sems, 8-32 x 3/4      |
| 99    | 650223      | 0   | Screw, Fil. slotted hd. Sems, 8-32 x 5/8     |
| 99    | 650688      | 0   | Screw, Hex hd., 10-32 x 1-5/16" (Drilled     |
| 101   | 30209       | 0   | Elbow, Exhaust (45°)                         |
| 101   | 32394       | 0   | Elbow, Exhaust (90°)                         |
| 103C  | 31287       | 0   | Muffler                                      |
| 104   | 28443       | 0   | Nut, Conduit (1/8" thick)                    |
| 104   | 32862       | 0   | Nut, Conduit (1/4" thick)                    |
| 110   | 31913       | 0   | Nipple, Pipe (3")                            |
| 115   | 32387A      | 0   | Cap, Fuel filler (Charcoal Plastic) (Spurt   |
| 115   | 33032       | 0   | Cap, Fuel filler (Red Plastic) (Spurt        |
| 118   | 29774       | 0   | Line, Fuel (Braided 8.25")                   |
| 118   | 30705       | 0   | Line, Fuel (Braided 16")                     |
| 118   | 30962       | 0   | Line, Fuel (Braided 32")                     |
| 125   | 27930       | 0   | Gasket, Exhaust                              |
| 145   | 31752       | 0   | Decal, Air cleaner                           |
| 146   | 28451       | 0   | Gasket, Housing                              |
| 171   | 24590       | 0   | Plug, Pipe                                   |
| 215   | 28301       | 0   | Pulley, Starter                              |
| 216   | 590343      | 0   | Rope & Handle Assy., Starter                 |
| 228   | 30820       | 0   | Baffle, Heat                                 |
| 229   | 28942       | 0   | Screw  |



| Ref # | Part Number | Qty | Description                         |
|-------|-------------|-----|-------------------------------------|
| 230   | 650257      | 0   | Screw, Pan hd. Sems, 8-32 x 5/16    |
| 253   | 30767       | 0   | Spacer, Air cleaner                 |
| 255   | 28820       | 0   | Screw                               |
| 256   | 650760      | 0   | Screw                               |
| 257   | 31291       | 0   | Plug, Cover                         |
| 262   | 29716       | 0   | Screw                               |
| 265   | 650701      | 0   | Screw, Hex washer hd. shakeproof,   |
| 266   | 26460       | 0   | Clamp, Fuel line                    |
| 289   | 730512      | 0   | Kit, Pre-cleaner                    |
| 290   | 31667       | 0   | Spring, Pre-cleaner bag             |
| 291   | 31668       | 0   | Bag, Pre-cleaner                    |
| 327   | 730128      | 0   | Cleaner Assy., Air                  |
| 328   | 730127      | 0   | Cleaner Assy., Air (Poly)           |
| 342   | 29212       | 0   | Screw                               |
| 347   | 31288       | 0   | Muffler Adapter Kit                 |
| 348   | 730130      | 0   | Muffler Adapter Kit                 |
| 349   | 6021        | 0   | Screw                               |
| 350   | 650697      | 0   | Screw, Hex hd. cap, 5/16-18 x 2-1/2 |
| 351   | 650178      | 0   | Screw                               |
| 353   | 30803       | 0   | Bracket Kit, Air cleaner            |
| 360   | 631063A     | 0   | Carburetor                          |