

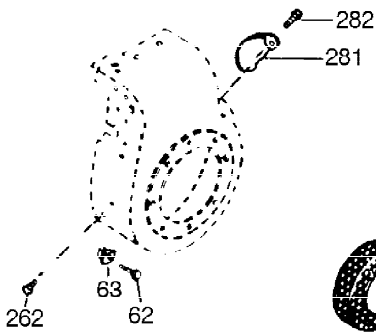

| Ref # | Part Number | Qty | Description                                  |
|-------|-------------|-----|--|
| 1     | 35123A      | 1   | Cylinder (Incl. 2, 20 & 72)                  |
| 2     | 27652       | 2   | Dowel Pin                                    |
| 4     | 30968       | 1   | Oil Drain Extension                          |
| 5     | 30969       | 1   | Extension Cap                                |
| 15B   | 650494      | 1   | Screw, 6-40 x 5/16"                          |
| 15    | 30699C      | 1   | Governor Rod (Incl. 15A & 15B)               |
| 15A   | 30700       | 1   | Governor Yoke                                |
| 16    | 33454       | 1   | Governor Lever                               |
| 17    | 29916       | 1   | Governor Lever Clamp                         |
| 18    | 650548      | 1   | Screw, 8-32 x 5/16"                          |
| 19    | 34663       | 1   | Speed Control Spring                         |
| 20    | 32630       | 1   | Oil Seal                                     |
| 25    | 36460       | 1   | Blower Housing Baffle                        |
| 26    | 650561      | 2   | Screw, 1/4-20 x 5/8"                         |
| 28    | 30322       | 1   | Lock Nut, 8-32                               |
| 30    | 35192       | 1   | Crankshaft                                   |
| 35    | 29826       | 1   | Screw, 10-32 x 3/4"                          |
| 36    | 29918       | 1   | Lock Washer                                  |
| 37    | 29216       | 1   | Lock Nut, 10-32                              |
| 38    | 29642       | 1   | Retaining Ring                               |
| 40    | 34531       | 1   | Piston, Pin & Ring Set (Std.)                |
| 40    | 34532       | 1   | Piston, Pin & Ring Set (.010" OS)            |
| 40    | 34533       | 1   | Piston, Pin & Ring Set (.020" OS)            |
| 41    | 33312B      | 1   | Piston & Pin Ass'y. (Std.) (Incl. 43)        |
| 41    | 33313B      | 1   | Piston & Pin Ass'y. (.010" OS) (Incl. 43)    |
| 41    | 33314B      | 1   | Piston & Pin Ass'y. (.020" OS) (Incl. 43)    |
| 42    | 34854       | 1   | Ring Set (Std.)                              |
| 42    | 34855       | 1   | Ring Set (.010" OS)                          |
| 42    | 34856       | 1   | Ring Set (.020" OS)                          |
| 43    | 27888       | 2   | Piston Pin Retaining Ring                    |
| 45    | 31380C      | 1   | Connecting Rod Ass'y. (Incl. 46)             |
| 46    | 650662C     | 2   | Connecting Rod Bolt                          |
| 48    | 34034       | 2   | Valve Lifter                                 |
| 50    | 33931       | 1   | Camshaft (MCR)                               |
| 60    | 30622A      | 1   | Blower Housing Extension                     |
| 65    | 650128      | 1   | Screw, 10-24 x 1/2"                          |
| 69    | 30684       | 1   | * Cylinder Cover Gasket                      |
| 70    | 32729       | 1   | Cylinder Cover (Incl. 74,75,76,80,175 & 176) |
| 72    | 27642       | 1   | Oil Drain Plug                               |
| 75    | 28460       | 1   | Oil Seal                                     |
| 76    | 28926       | 1   | Camshaft Seal                                |
| 80    | 31845       | 1   | Governor Shaft                               |
| 81    | 30590A      | 1   | Washer                                       |
| 82    | 30591       | 1   | Governor Gear Ass'y. (Incl. 81)              |
| 83    | 30588A      | 1   | Governor Spool                               |
| 84    | 29193       | 1   | Retaining Ring                               |
| 86    | 650488      | 7   | Screw, 1/4-20 x 1-1/4"                       |
| 87    | 650493      | 1   | Screw, 1/4-20 x 1-3/4"                       |
| 89    | 32589       | 1   | Flywheel Key                                 |
| 90    | 611085      | 1   | Flywheel (W/Ring Gear)                       |
| 92    | 650815      | 1   | Belleville Washer                            |
| 93    | 8116        | 1   | Flywheel Nut                                 |
| 100   | 34443A      | 1   | Solid State Ignition                         |
| 101   | 610118      | 1   | Spark Plug Cover                             |
| 102   | 650872      | 2   | Solid State Mounting Stud                    |

| Ref # | Part Number | Qty | Description                           |
|-------|-------------|-----|---------------------------------------|
| 103   | 650814      | 2   | Screw, Torx T-15, 10-24 x 1"          |
| 110   | 35187       | 1   | Ground Wire                           |
| 119   | 36445       | 1   | * Cylinder Head Gasket                |
| 120   | 36446       | 1   | Cylinder Head (Incl. 3 of 130)        |
| 125   | 27878A      | 1   | Exhaust Valve (Std.) (Incl. 151)      |
| 125   | 27880A      | 1   | Exhaust Valve (1/32" OS) (Incl. 151)  |
| 126   | 32783       | 1   | Intake Valve (Std.) (Incl. 151)       |
| 126   | 32784       | 1   | Intake Valve (1/32" OS) (Incl. 151)   |
| 127   | 650691      | 3   | Washer                                |
| 128   | 650690      | 3   | Belleville Washer                     |
| 130   | 650697A     | 8   | Screw, 5/16-18 x 2-1/2"               |
| 135   | 33636       | 1   | Resistor Spark Plug (RJ17LM)          |
| 139   | 31843A      | 1   | Governor Gear Bracket                 |
| 140   | 650965      | 2   | Screw, Torx T-25, 10-24 x 1/2"        |
| 149   | 27882       | 2   | Valve Spring Cap                      |
| 150   | 27881       | 2   | Valve Spring                          |
| 151   | 32581       | 2   | Valve Spring Keeper                   |
| 169   | 27896A      | 2   | * Breather Gasket                     |
| 170   | 28423       | 1   | Breather Body                         |
| 171   | 28424       | 1   | Breather Element                      |
| 172   | 28425       | 1   | Valve Cover                           |
| 173A  | 32446       | 1   | Breather Tube Grommet                 |
| 173   | 32447       | 1   | Breather Tube                         |
| 174   | 650128      | 2   | Screw, 10-24 x 1/2"                   |
| 182   | 650517      | 2   | Screw, 1/4-20 x 27/32"                |
| 184   | 31688A      | 1   | * Carburetor To Intake Pipe Gasket    |
| 186   | 34661       | 1   | Governor Link                         |
| 200   | 34664       | 1   | Control Bracket (Incl.19,203,204,206) |
| 203   | 31342       | 1   | Compression Spring                    |
| 204   | 650549      | 1   | Screw, 5-40 x 7/16"                   |
| 206   | 610973      | 1   | Terminal                              |
| 207   | 34662       | 1   | Throttle Link                         |
| 209   | 650821      | 2   | Screw, 10-32 x 1/2"                   |
| 210   | 27793       | 1   | Conduit Clip                          |
| 211   | 28942       | 1   | Screw, 10-32 x 3/8"                   |
| 224   | 27915A      | 1   | * Intake Pipe Gasket                  |
| 227   | 34780       | 1   | Air Cleaner Elbow                     |
| 239   | 27272A      | 1   | * Air Cleaner Gasket                  |
| 242   | 34699       | 1   | Air Cleaner Bracket                   |
| 245   | 34782       | 1   | Air Cleaner Filter                    |
| 250   | 35601       | 1   | Air Cleaner Cover                     |
| 260   | 35891       | 1   | Blower Housing                        |
| 262   | 29747B      | 2   | Screw, Torx T-40, 5/16-24 x 21/32"    |
| 265   | 30939A      | 1   | Cylinder Head Cover                   |
| 269   | 35865       | 1   | * Exhaust Manifold Gasket             |
| 272   | 30196       | 2   | Screw, 5/16-18 x 3/4"                 |
| 273   | 34712       | 1   | Carburetor Flange                     |
| 275   | 32401       | 1   | Muffler                               |
| 277   | 650694A     | 1   | Screw, 5/16-18 x 2"                   |
| 277A  | 30196       | 1   | Screw, 5/16-18 x 3/4"                 |
| 279B  | 26073       | 1   | Washer                                |
| 285   | 35287A      | 1   | Starter Cup                           |
| 287   | 650926      | 3   | Screw, 8-32 x 21/64"                  |
| 290   | 29774       | 1   | Fuel Line                             |
| 292   | 26460       | 2   | Fuel Line Clamp                       |

| Ref # | Part Number | Qty | Description   |
|-------|-------------|-----|---|
| 298   | 650665      | 2   | Screw, 1/4-15 x 3/4"  |
| 300   | 34156A      | 1   | Fuel Tank (Incl. 292 & 301)   |
| 301   | 35355       | 1   | Fuel Cap  |
| 305   | 35554       | 1   | Oil Fill Tube   |
| 307   | 35499       | 1   | "O" Ring  |
| 308   | 35540       | 1   | Fill Tube Clip  |
| 310   | 35595       | 1   | Dipstick  |
| 325   | 29443       | 1   | Conduit Clip  |
| 327   | 35392       | 1   | Starter Plug  |
| 340   | 34168A      | 1   | Fuel Tank Bracket   |
| 341   | 34167       | 1   | Fuel Tank Bracket   |
| 342   | 30063       | 1   | Screw, Torx T-30, 1/4-20 x 1/2"   |
| 355   | 590701      | 1   | Starter Handle  |
| 370A  | 35532       | 1   | Name Decal  |
| 370   | 36261       | 1   | Instruction Decal   |
| 370C  | 34704       | 1   | Instruction Decal   |
| 370B  | 35274       | 1   | Instruction Decal   |
| 380   | 632257      | 1   | Carburetor (Incl. 184)  |
| 390   | 590688      | 1   | Rewind Starter (Note: This engine could have been built with 590694 starter. Refer to the design of the air intake louvers for part identification. Individual starter parts do not interchange.) |
| 400   | 36447       | 1   | * Gasket Set (Incl. items marked PK i n notes) Incl. part #'s 26756 (1), 27272A (1), 27896A (2), 27915A (1), 29673 (1), 30684 (1), 31688A (1), 33629 (1), 34912 (1), 35865 (1), 36445 (1)         |
| 420   | 730225      | 1   | SAE 30 4-Cycle Engine Oil (Quart)   |
| 453   | 29538       | 1   | Engine Mounting Base  |
| 454   | 650542      | 4   | Screw, 5/16-18 x 3/4"   |



**OPTIONAL 110-120  
VOLT STARTER  
MOTOR KIT**

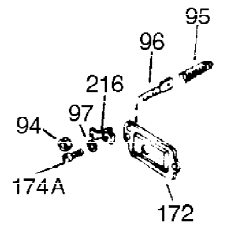
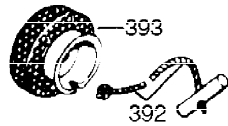

| Ref # | Part Number | Qty | Description                        |
|-------|-------------|-----|------------------------------------|
| 23    | 31793       | 1   | Ball Bearing                       |
| 32    | 31792       | 1   | Thrust Washer                      |
| 74    | 31855       | 2   | Bearing Retainer                   |
| 172   | 28425       | 1   | Valve Cover                        |
| 175   | 650778      | 2   | Lock Washer                        |
| 176   | 650580      | 2   | Lock Nut, 10-24                    |
| 262   | 29747B      | 2   | Screw, Torx T-40, 5/16-24 x 21/32" |
| 269   | 35865       | 1   | * Exhaust Manifold Gasket          |
| 277A  | 30196       | 1   | Screw, 5/16-18 x 3/4"              |
| 281   | 33013       | 1   | Starter Bubble Cover               |
| 282   | 650760      | 1   | Screw, 8-32 x 3/8"                 |
| 370C  | 34704       | 1   | Instruction Decal                  |



**OPTIONAL  
STARTER MUFF KIT**



730571

Can be used on H50-60 with  
stamped steel starter.



| Ref # | Part Number | Qty | Description                  |
|-------|-------------|-----|------------------------------|
| 90    | 611085      | 1   | Flywheel (W/Ring Gear)       |
| 228   | 650826      | 1   | Stud, 1/4-20 x 6.20          |
| 229   | 650825      | 1   | Nut & Lock Washer, 1/4-20    |
| 232   | xxxxx       | 2   | Pop Rivet (Purchase Locally) |
| 235   | 30675       | 1   | Breather Tube Fitting        |
| 238A  | 650163      | 2   | Screw, 10-32 x 7/8"          |
| 239   | 27272A      | 1   | * Air Cleaner Gasket         |
| 239A  | 34698A      | 1   | Air Cleaner Gasket           |
| 242   | 34699       | 1   | Air Cleaner Bracket          |
| 245   | 34782       | 1   | Air Cleaner Filter           |
| 245A  | 34783       | 1   | Air Cleaner Filter           |
| 250   | 35601       | 1   | Air Cleaner Cover            |
| 251   | 650513      | 1   | Wing Nut, 1/4-20             |
| 370C  | 34704       | 1   | Instruction Decal            |