



| Ref # | Part Number | Qty | Description |
|-------|-------------|-----|----------------------------------------------|
| 1 | 32176A | 0 | Cylinder Assy, (2-5/8" Bore) |
| 2 | 27652 | 0 | Pin, Dowel |
| 3A | 27642 | 0 | Plug, Drain |
| 3 | 27642 | 0 | Plug, Drain |
| 4 | 27876B | 0 | Seal, Oil |
| 5 | 31467A | 0 | Valve, Intake (Standard) (Long Life) |
| 5 | 31468A | 0 | Valve, Intake (1/32" Oversize) (Long Life) |
| 6 | 31469A | 0 | Valve, Exhaust (Standard) (Long Life) |
| 6 | 31470 | 0 | Valve, Exhaust (1/32" Oversize) (Long Life) |
| 7 | 27882 | 0 | Cap, Upper valve spring |
| 8 | 27881 | 0 | Spring, Valve |
| 9A | 27883 | 0 | Cap, Lower valve spring (Standard) |
| 9A | 30964 | 0 | Cap, Lower valve spring (1/32" oversize) |
| 9 | 27883 | 0 | Cap, Lower valve spring (Standard) |
| 9 | 30964 | 0 | Cap, Lower valve spring (1/32" oversize) |
| 10 | 20810 | 0 | Pin, Valve spring retaining |
| 11 | 31791 | 0 | Crankshaft Assy. |
| 12 | 29783 | 0 | Pin, Crankshaft gear |
| 13 | 27884 | 0 | Gear, Crankshaft |
| 14 | 31797 | 0 | Piston & Pin Assy. (Standard) (2-5/8") |
| 14 | 31798 | 0 | Piston & Pin Assy. (.010 Oversize) |
| 14 | 31799 | 0 | Piston & Pin Assy. (.020 Oversize) |
| 15 | 29909 | 0 | Re-Ringing Set, Piston |
| 15 | 31854 | 0 | Ring Set, Piston (Standard) (2-5/8") (Long |
| 15 | 32057 | 0 | Ring Set, Piston (.010 Oversize) |
| 15 | 32058 | 0 | Ring Set, Piston (.020 Oversize) |
| 16 | 27888 | 0 | Ring, Piston pin retaining |
| 17 | 31380 | 0 | Rod'Assy., Connecting |
| 18 | 30682 | 0 | Bolt, Connecting rod |
| 19 | 26073 | 0 | Washer, Connecting rod bolt |
| 20 | 28264 | 0 | Nut |
| 21 | 32178 | 0 | Camshaft Assy. (Ext.) (Mech. compression |
| 22 | 27893 | 0 | Lifter, Valve |
| 23 | 32103 | 0 | Cover, Cylinder |
| 24A | 28926 | 0 | Seal, Oil (Camshaft) |
| 24 | 28427 | 0 | Seat, Oil |
| 25 | 29668 | 0 | Dipstick, Oil (Screw In) |
| 26 | 30684 | 0 | Gasket, Mounting flange |
| 27 | 8303 | 0 | Lockwasher |
| 28 | 30564 | 0 | Screw |
| 28 | 650488 | 0 | Screw |
| 30 | 29673 | 0 | Gasket, Filler plug |
| 31 | 650489 | 0 | Screw |
| 32 | 28938B | 0 | Gasket, Cylinder head |
| 33 | 30938A | 0 | Head, Cylinder |
| 34 | 27793 | 0 | Clip, Conduit |
| 35 | 28942 | 0 | Screw |
| 36 | 650694 | 0 | Screw, Hex hd. cap, 5/16-18 x 2 |
| 36 | 650695 | 0 | Screw, Hex hd. cap, 5/16-18 x 2-1/4 (Grade 8 |
| 36 | 650697 | 0 | Screw, Hex hd. cap, 5/16-18 x 2-1/2 |
| 37 | 33636 | 0 | Plug, Spark (Champion J-8 or equivalent) |
| 38 | 27896 | 0 | Gasket, Breather cover |
| 39 | 28423 | 0 | Body, Breather |
| 40 | 28424 | 0 | Element, Breather |
| 41 | 28425 | 0 | Cover, Valve chamber |

| Ref # | Part Number | Qty | Description |
|-------|-------------|-----|------------------------------------------|
| 42 | 26073 | 0 | Washer, Connecting rod bolt |
| 43 | 650128 | 0 | Screw |
| 43 | 650597 | 0 | Screw, Hex washer hd., 10-24 x 5/8 |
| 43A | 8269 | 0 | Washer |
| 44 | 27627 | 0 | Tube, Breather |
| 45 | 27915 | 0 | Gasket, Intake pipe |
| 46 | 30195A | 0 | Flange, Carburetor |
| 48 | 30196 | 0 | Screw |
| 50 | 650548 | 0 | Screw, Hex washer hd., 8-32 x 5/16 |
| 51 | 30319 | 0 | Rivet, Split |
| 52 | 31709 | 0 | Lever, Governor |
| 54 | 28819 | 0 | Spring, Fuel line |
| 54 | 31778 | 0 | Spring, Coil |
| 55 | 30205 | 0 | Bracket, Adjusting |
| 56 | 31710 | 0 | Link, Throttle |
| 57 | 30985 | 0 | Control, Throttle |
| 57A | 24522 | 0 | Control, Throttle |
| 59 | 29216 | 0 | Nut |
| 60 | 650152 | 0 | Screw |
| 61 | 29826 | 0 | Screw |
| 62 | 29642 | 0 | Ring, Retaining |
| 63 | 30699A | 0 | Rod Assy., Governor |
| 64 | 29536 | 0 | Baffle, Blower housing |
| 65 | 650561 | 0 | Screw |
| 66 | 30586 | 0 | Decal, Instruction |
| 67 | 650399 | 0 | Screw, Phil. fil. hd. Sems, 10-32 x 5/8 |
| 68 | 8274 | 0 | Lockwasher |
| 69 | 29747A | 0 | Screw |
| 70 | 32158B | 0 | Housing, (5.56 Dia. starter mtg. bolt |
| 71 | 650490 | 0 | Washer, Belleville |
| 72 | 8116 | 0 | Nut |
| 73 | 30700 | 0 | Yoke, Governor |
| 74 | 650494 | 0 | Screw |
| 75 | 31688 | 0 | Gasket, Carburetor (1/8 thick) |
| 77 | 31345 | 0 | Plate, Identification |
| 78 | 29309 | 0 | Stud, Drive |
| 79 | 29752 | 0 | Nut |
| 80 | 650572 | 0 | Screw |
| 83 | 27272 | 0 | Gasket, Air cleaner |
| 88 | 650399 | 0 | Screw, Phil. fil. hd. Sems, 10-32 x 5/8 |
| 88 | 650521 | 0 | Screw |
| 88 | 28820 | 0 | Screw |
| 91 | 30312 | 0 | Screw, Hex washer hd. Sems, 10-32 x 1/2 |
| 98 | 28569 | 0 | Spring, Compression |
| 98 | 32924 | 0 | Spring, Compression |
| 99 | 29500 | 0 | Screw, Fil. hd. mach., Sems, 8-32 x 3/4 |
| 99 | 650223 | 0 | Screw, Fil. slotted hd. Sems, 8-32 x 5/8 |
| 99 | 650688 | 0 | Screw, Hex hd., 10-32 x 1-5/16" (Drilled |
| 100 | 29538 | 0 | Base, Mounting |
| 102 | 650561 | 0 | Screw |
| 103 | 32401 | 0 | Muffler |
| 105 | 31793 | 0 | Bearing, Ball |
| 106 | 31845 | 0 | Shaft, Mechanical governor |
| 108 | 29193 | 0 | Ring, Retaining |
| 109 | 30588A | 0 | Spool, Governor |

| Ref # | Part Number | Qty | Description |
|-------|-------------|-----|---------------------------------------------|
| 111 | 31694 | 0 | Bracket, Fuel tank |
| 113 | 30688 | 0 | Screw, Hex hd. Sems, 1/4-20 x 1/2 |
| 113 | 650561 | 0 | Screw |
| 114 | 31301 | 0 | Tank Assy., Fuel (1 gal.) |
| 115A | 30998B | 0 | Cap, Fuel filler (Red Plastic) (Sno Proof) |
| 115 | 32387A | 0 | Cap, Fuel filler (Charcoal Plastic) (Spurt |
| 115 | 33032 | 0 | Cap, Fuel filler (Red Plastic) (Spurt |
| 117A | 29683 | 0 | Strainer & Shut-off |
| 118 | 29774 | 0 | Line, Fuel (Braided 8.25") |
| 118 | 30705 | 0 | Line, Fuel (Braided 16") |
| 118 | 30962 | 0 | Line, Fuel (Braided 32") |
| 119 | 31792 | 0 | Washer, Thrust |
| 120 | 30688 | 0 | Screw, Hex hd. Sems, 1/4-20 x 1/2 |
| 120 | 650128 | 0 | Screw |
| 121 | 30622 | 0 | Extension, Blower housing |
| 125 | 27930 | 0 | Gasket, Exhaust |
| 126 | 650178 | 0 | Screw |
| 127 | 26073 | 0 | Washer, Connecting rod bolt |
| 128 | 30196 | 0 | Screw |
| 128 | 650694 | 0 | Screw, Hex hd. cap, 5/16-18 x 2 |
| 129 | 30884 | 0 | Key, Flywheel |
| 130 | 31843A | 0 | Bracket, Governor |
| 131 | 28763 | 0 | Screw, Hex washer hd. thread-forming, 10-24 |
| 132 | 30091 | 0 | Screw, Hex slotted washer hd., 8-32 x 1/2 |
| 132 | 650548 | 0 | Screw, Hex washer hd., 8-32 x 5/16 |
| 133 | 650599 | 0 | Screw, Hex hd. cap, Sems, 1/4-20 x 1-1/2 |
| 144 | 650542 | 0 | Screw, Hex hd. cap, 5/16 18 x 13/16 |
| 145 | 31786 | 0 | Decal, Air cleaner |
| 149 | 30747 | 0 | Clip, Shorting |
| 149 | 31861 | 0 | Clip, Shorting |
| 150 | 16645 | 0 | Lockwasher |
| 151 | 30066 | 0 | Screw |
| 152 | 30063 | 0 | Screw |
| 152 | 30688 | 0 | Screw, Hex hd. Sems, 1/4-20 x 1/2 |
| 153 | 30064 | 0 | Cover, Rectifier panel |
| 154 | 30065 | 0 | Nut, Long 5-40 |
| 155 | 31324 | 0 | Decal, Name & H.P., (6 H.P.) |
| 155 | 31325 | 0 | Decal, Name & H.P. (5 H.P.) |
| 155 | 31328 | 0 | Decal, Name & H.P., (4 H.P.) |
| 156 | 28728 | 0 | Nut |
| 157 | 28727 | 0 | Lockwasher |
| 159 | 28726 | 0 | Screw, Phil. rd. hd., 5-40 x 9/16 |
| 160 | 30595 | 0 | Decal, Ezee-start |
| 162 | 29918 | 0 | Lockwasher |
| 164 | 30322 | 0 | Nut & Lockwasher |
| 165 | 29916 | 0 | Clamp, Governor lever |
| 176 | 30972 | 0 | Bracket, Choke control |
| 177 | 29774 | 0 | Line, Fuel (Braided 8.25") |
| 182 | 30063 | 0 | Screw |
| 182 | 30688 | 0 | Screw, Hex hd. Sems, 1/4-20 x 1/2 |
| 184 | 29521 | 0 | Pin, Dowel |
| 194 | 31478 | 0 | Decal, H.P. (4 H.P.) |
| 194 | 31517 | 0 | Decal, H.P. (5 H.P.) |
| 194 | 32173 | 0 | Decal, H.P. (6 H.P.) |
| 206 | 30590A | 0 | Washer, Flat |

| Ref # | Part Number | Qty | Description |
|-------|-------------|-----|---------------------------------|
| 209 | 30939 | 0 | Cover, Cylinder head |
| 232 | 31548 | 0 | Knob, Seed control |
| 232 | 32410 | 0 | Knob, Speed control |
| 238 | 650489 | 0 | Screw |
| 253 | 30767 | 0 | Spacer, Air cleaner |
| 260 | 29752 | 0 | Nut |
| 260 | 650116 | 0 | Nut, Lock |
| 260 | 650456 | 0 | Nut, Lock |
| 261 | 650168 | 0 | Washer, Flat |
| 262 | 29716 | 0 | Screw |
| 264 | 32125 | 0 | Cup, Starter |
| 264A | 590417 | 0 | Screen, Starter cup |
| 266 | 26460 | 0 | Clamp, Fuel line |
| 267 | 33356 | 0 | Terminal, Ground |
| 268 | 31584 | 0 | Cup, Spark plug |
| 269 | 31583 | 0 | Clamp, Wire |
| 270 | 31461 | 0 | Bushing, Crankshaft |
| 271 | 31546 | 0 | Bushing, Crankshaft |
| 272 | 31660 | 0 | Cover, Fuel pump pad |
| 273 | 31711A | 0 | Bracket Assy., Speed control |
| 275 | 31386 | 0 | Spring, Governor |
| 276 | 31697 | 0 | Strap, Fuel tank |
| 277 | 29212 | 0 | Screw |
| 277 | 650451 | 0 | Screw |
| 278 | 6202 | 0 | Screw |
| 286 | 27275 | 0 | Clip, Hi-tension wire |
| 286 | 29443 | 0 | Clip, Fuel line |
| 289 | 730512 | 0 | Kit, Pre-cleaner |
| 290 | 31667 | 0 | Spring, Pre-cleaner bag |
| 291 | 31668 | 0 | Bag, Pre-cleaner |
| 296A | 650147 | 0 | Washer, Flat |
| 296 | 28942 | 0 | Screw |
| 296 | 650229 | 0 | Screw |
| 305 | 30547A | 0 | Contact Assy., Breaker |
| 306 | 30548A | 0 | Condenser |
| 307 | 631021 | 0 | Inlet Needle, Seat & Clip Assy. |
| 309 | 31855 | 0 | Retainer, Bearing |
| 310 | 27183 | 0 | Washer, Fiber |
| 311 | 650580 | 0 | Nut, Lock |
| 318 | 650583 | 0 | Washer, Flat |
| 328 | 730127 | 0 | Cleaner Assy., Air (Poly) |
| 335 | 32130 | 0 | Decal, Long Life |
| 352 | 8274 | 0 | Lockwasher |
| 360 | 631067A | 0 | Carburetor |
| 361 | 610689A | 0 | Magneto, Tecumseh |
| 361A | 33018 | 0 | Harness, Adapter |
| 362 | 590420 | 0 | Starter, Rewind |
| 363 | 29965 | 0 | Motor, Starter (12 Volt) |
| 363 | 32468 | 0 | Motor, Starter (12 Volt) |
| 363 | 32468A | 0 | Motor, Starter (12 Volt) |
| 363 | 32468B | 0 | Motor, Starter (12 Volt) |
| 364 | 33235 | 0 | Gasket Set |

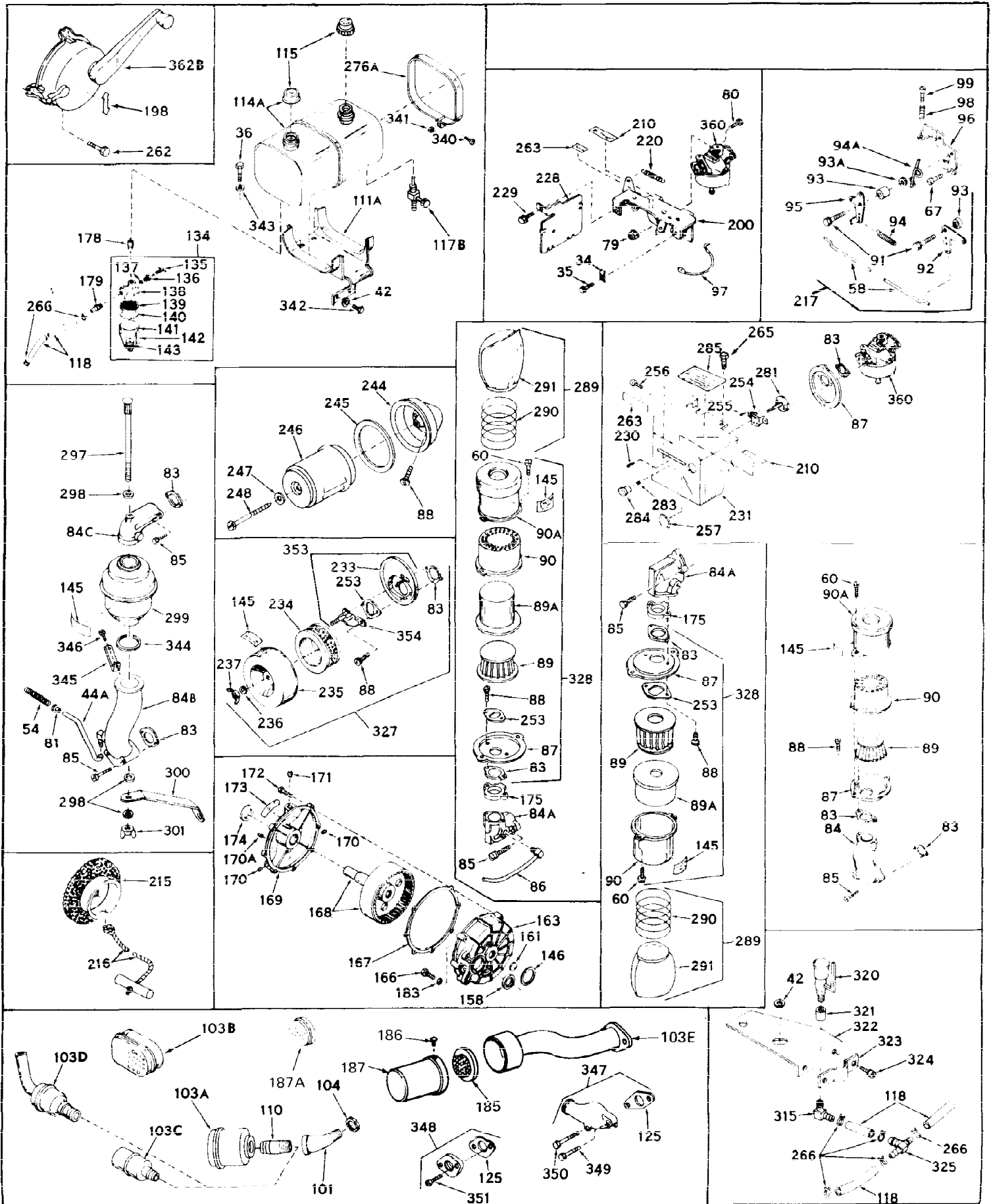

| Ref # | Part Number | Qty | Description |
|-------|-------------|-----|----------------------------------------------|
| 34 | 27793 | 0 | Clip, Conduit |
| 35 | 28942 | 0 | Screw |
| 36 | 650694 | 0 | Screw, Hex hd. cap, 5/16-18 x 2 |
| 36 | 650695 | 0 | Screw, Hex hd. cap, 5/16-18 x 2-1/4 (Grade 8 |
| 36 | 650697 | 0 | Screw, Hex hd. cap, 5/16-18 x 2-1/2 |
| 42 | 26073 | 0 | Washer, Connecting rod bolt |
| 54 | 28819 | 0 | Spring, Fuel line |
| 54 | 31778 | 0 | Spring, Coil |
| 60 | 650152 | 0 | Screw |
| 67 | 650399 | 0 | Screw, Phil. fil. hd. Sems, 10-32 x 5/8 |
| 79 | 29752 | 0 | Nut |
| 80 | 650572 | 0 | Screw |
| 83 | 27272 | 0 | Gasket, Air cleaner |
| 84C | 31810 | 0 | Elbow, Air cleaner |
| 85 | 29786 | 0 | Screw |
| 85 | 650163 | 0 | Screw, Fil. hd. Sems, 10-32 x 7/8 |
| 85 | 650416 | 0 | Screw, Rd. hd. Sems, 10-32 x 1 |
| 85 | 650605 | 0 | Screw |
| 88 | 650399 | 0 | Screw, Phil. fil. hd. Sems, 10-32 x 5/8 |
| 88 | 650521 | 0 | Screw |
| 88 | 28820 | 0 | Screw |
| 91 | 30312 | 0 | Screw, Hex washer hd. Sems, 10-32 x 1/2 |
| 98 | 28569 | 0 | Spring, Compression |
| 98 | 32924 | 0 | Spring, Compression |
| 99 | 29500 | 0 | Screw, Fil. hd. mach., Sems, 8-32 x 3/4 |
| 99 | 650223 | 0 | Screw, Fil. slotted hd. Sems, 8-32 x 5/8 |
| 99 | 650688 | 0 | Screw, Hex hd., 10-32 x 1-5/16" (Drilled |
| 104 | 28443 | 0 | Nut, Conduit (1/8" thick) |
| 104 | 32862 | 0 | Nut, Conduit (1/4" thick) |
| 115 | 32387A | 0 | Cap, Fuel filler (Charcoal Plastic) (Spurt |
| 115 | 33032 | 0 | Cap, Fuel filler (Red Plastic) (Spurt |
| 118 | 29774 | 0 | Line, Fuel (Braided 8.25") |
| 118 | 30705 | 0 | Line, Fuel (Braided 16") |
| 118 | 30962 | 0 | Line, Fuel (Braided 32") |
| 125 | 27930 | 0 | Gasket, Exhaust |
| 145 | 31786 | 0 | Decal, Air cleaner |
| 146 | 28451 | 0 | Gasket, Housing |
| 171 | 24590 | 0 | Plug, Pipe |
| 215 | 28301 | 0 | Pulley, Starter |
| 216 | 590343 | 0 | Rope & Handle Assy., Starter |
| 228 | 30820 | 0 | Baffle, Heat |
| 229 | 28942 | 0 | Screw |
| 230 | 650257 | 0 | Screw, Pan hd. Sems, 8-32 x 5/16 |
| 236 | 31481 | 0 | Washer, Copper |
| 237 | 650513 | 0 | Nut, Wing |
| 253 | 30767 | 0 | Spacer, Air cleaner |
| 255 | 28820 | 0 | Screw |
| 256 | 650760 | 0 | Screw |
| 257 | 31291 | 0 | Plug, Cover |
| 262 | 29716 | 0 | Screw |
| 265 | 650701 | 0 | Screw, Hex washer hd. shakeproof, |
| 266 | 26460 | 0 | Clamp, Fuel line |
| 289 | 730512 | 0 | Kit, Pre-cleaner |
| 290 | 31667 | 0 | Spring, Pre-cleaner bag |
| 291 | 31668 | 0 | Bag, Pre-cleaner |

| Ref # | Part Number | Qty | Description |
|-------|-------------|-----|-------------------------------------|
| 298 | 27183 | 0 | Washer, Fiber |
| 299 | 31820 | 0 | Cleaner Assy., Oil bath |
| 300 | 31821 | 0 | Brace, Cleaner |
| 327 | 730128 | 0 | Cleaner Assy., Air |
| 328 | 730127 | 0 | Cleaner Assy., Air (Poly) |
| 342 | 29212 | 0 | Screw |
| 347 | 31288 | 0 | Muffler Adapter Kit |
| 348 | 730130 | 0 | Muffler Adapter Kit |
| 349 | 6021 | 0 | Screw |
| 350 | 650697 | 0 | Screw, Hex hd. cap, 5/16-18 x 2-1/2 |
| 351 | 650178 | 0 | Screw |
| 353 | 30803 | 0 | Bracket Kit, Air cleaner |
| 360 | 631067A | 0 | Carburetor |