

5 HP CHAIN DRIVE TILLER
MODEL 23-5350G

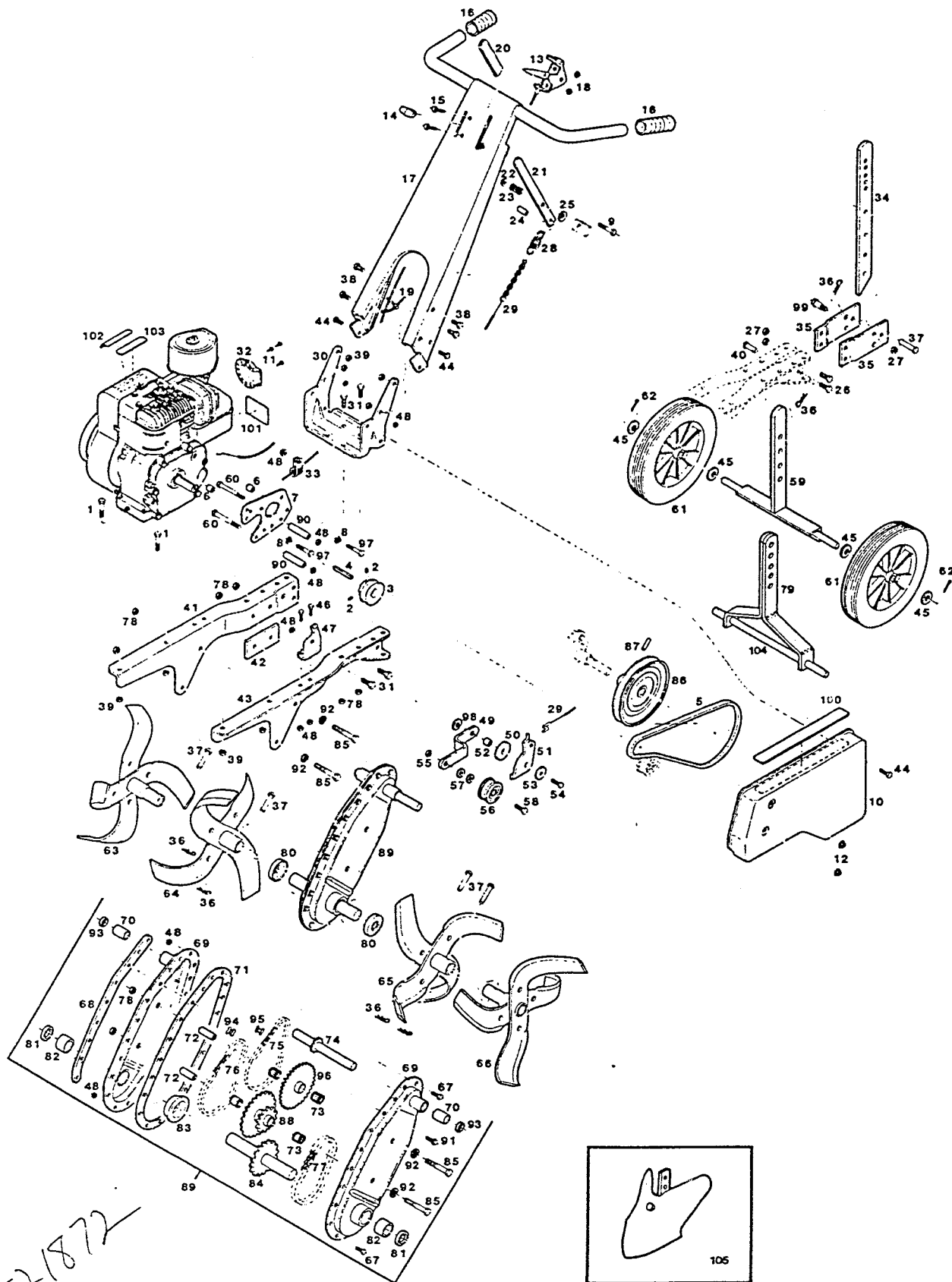

521872

**5 HP CHAIN DRIVE TILLER
MODEL 23-5350G**

| Ref. No. | Part No. | Description | Ref. No. | Part No. | Description |
|---------------------------|----------|---------------------------------|----------|----------|--------------------------------------|
| 1 | 150250 | Bolt—Hex 5/16-18 x 1-1/2 | 53 | 461236 | Washer—Flat 33/64 x 1 5/8 x 11ga. |
| 2 | 458844 | Set Screw—Pulley | 54 | 459909 | Bolt—Hex 1/4-20 x 1 |
| 3 | 618744 | Pulley—Engine | 55 | 715524 | Nut—Hex 3/8-16 Jam |
| 4 | 446757 | Key—Pulley | 56 | 672923 | Pulley—Idler |
| 5 | 421321 | Belt—Drive | 57 | 461731 | Washer—Flat |
| 6 | 468678 | Spacer—Belt Guide | 58 | 457176 | Bolt—Hex 3/8 - 16 x 1 1/4 |
| 7 | 464206 | Guide—Belt | 59 | 773085 | Wheel Bracket Assembly |
| 8 | 715094 | Washer—Lock | 60 | 450007 | Bolt—Hex 1/4-20 x 3-1/4 |
| 9 | 450379 | Bolt—Hex 1/4-20 x 1-3/4 | 61 | 498808 | Wheel—10" |
| 10 | 570499 | Guard—Belt | 62 | 317016 | Cotter Pin 1/8 x 1 |
| 11 | 120048 | Screw—Muffler Deflector | 63 | 786749 | Tine Assembly—R.H. Outer |
| 12 | 715078 | Nut—Hex 1/4-20 Whiz | 64 | 786681 | Tine Assembly—R.H. Inner |
| 13 | 781419 | Control—Throttle w/Cable | 65 | 786665 | Tine Assembly—L.H. Inner |
| 14 | 744037 | Knob—Throttle Lever | 66 | 574749 | Tine Assembly—L.H. Outer |
| 15 | 458687 | Screw—Hex 10-24 x 1/2 | 67 | 715052 | Bolt—Hex 1/4-20 x 1/2 |
| 16 | 751032 | Grip—Handlebar | 68 | 426015 | Strap—Nut Plate |
| 17 | 570473 | Panel Assembly | 69 | 432260 | Transmission—Half w/bearings |
| 18 | 715334 | Nut—Hex 10-24 Keps | 70 | 423442 | Bearing—Input Shaft |
| 19 | 110379 | Cable Tie | 71 | 555151 | Gasket—Transmission Housing |
| 20 | 761585 | Grip—Lever | 72 | 432922 | Sleeve—Bearing |
| 21 | 422188 | Lever—Engaging | 73 | 423434 | Bearing—Sprocket |
| 22 | 451419 | Nut—Hex 1/4-20 Flange | 74 | 417469 | Shaft—Input w/Sprocket |
| 23 | 775072 | Spring—Lever | 75 | 425314 | Chain—Roller No. 35 |
| 24 | 468801 | Spacer—Spring | 76 | 425421 | Chain—Roller No. 420 |
| 25 | 715607 | Washer—Belleville | 77 | 425348 | Chain—Roller No. 50 |
| 26 | 457176 | Bolt—Hex 3/8-16 x 1-1/4 | 78 | 715441 | Nut—Hex 3/8-16 Keps |
| 27 | 715086 | Nut—Hex 3/8-16 Lock | 79 | 574780 | Wheel Bracket |
| 28 | 775155 | Spring—Cable | 80 | 762245 | Cover—Tine Hub Seal |
| 29 | 749523 | Cable—Control | 81 | 774547 | Seal—Output Shaft |
| 30 | 447011 | Channel—Handle Support | 82 | 423731 | Bearing—Output Shaft |
| 31 | 458968 | Bolt—Hex 3/8-16 x 1 | 83 | 468033 | Spacer—Tine Shaft |
| 32 | 132142 | Deflector—Muffler | 84 | 417501 | Shaft—Output w/Sprocket |
| 33 | 447979 | Clamp—Control Cable | 85 | 458927 | Bolt—Hex 3/8-16 x 2-3/4 |
| 34 | 435032 | Bar—Depth | 86 | 420968 | Pulley—Transmission |
| 35 | 571232 | Plate—Depth Bar | 87 | 314062 | Pin—Roll 1/4 x 1-1/8 |
| 36 | 715011 | Hairpin Cotter | 88 | 590000 | Sprocket—Lower w/bearings |
| 37 | 616532 | Pin—Clevis 3/8 x 1 - 9/16 | 89 | 432310 | Transmission Assembly |
| 38 | 450437 | Bolt—Hex 5/16-18 x 5/8 | 90 | 468686 | Spacer—Belt Guide |
| 39 | 715490 | Nut—Hex 5/16-18 | 91 | 153601 | Bolt—Hex 1/4-20 x 3/4 |
| 40 | 488940 | Pin—Clevis 1/2 x 1-1/4 | 92 | 461780 | Washer—3/8 T-Lock |
| 41 | 446955 | Beam—Main Support R.H. | 93 | 774695 | Seal—Input Shaft |
| 42 | 468058 | Spacer—Main Support Beam | 94 | 425124 | Master Link—No. 420 |
| 43 | 446930 | Beam—Main Support L.H. | 95 | 424903 | Master Link—No. 35 |
| 44 | 449587 | Bolt—Hex 1/4-20 x 5/8 | 96 | 590018 | Sprocket—Upper w/bearings |
| 45 | 151241 | Washer—Wheel | 97 | 150433 | Bolt—Hex 1/4-20 x 2 |
| 46 | 715045 | Bolt—Hex 1/4-20 x 3/4 | 98 | 152553 | Washer—Thrust 1/2 ID x .032 Hardened |
| 47 | 771006 | Bracket—Idler Mounting | 99 | 153650 | Bolt—shoulder 3/8-16 |
| 48 | 715508 | Nut—Hex 1/4-20 Lock | 100 | 551648 | Decal—Caution |
| 49 | 557330 | Arm—Idler | 101 | 551655 | Decal—Tine Warning |
| 50 | 462762 | Washer—Flat 1 1/8 x .327 x .060 | 102 | 551713 | Decal—Hand Placement |
| 51 | 463323 | Plate—Idler Pivot | 103 | 551846 | Decal—Caution Disengage |
| 52 | 467829 | Spacer—Pivot Plate | 104 | 557116 | Axle—Wheel |
| OPTIONAL ACCESSORY | | | | | |
| | | | 105 | 465823 | Furrowing Kit |
| | | | | 432849 | Gear Lube 8 oz. (not shown) |

Note: For additional tiller accessories consult your
your supplier or factory.

NOTE: Parts are right and left hand as viewed from operator position.
Specifications subject to change without prior notice.