

MODEL: 53C
5 HP ROTARY TILLER

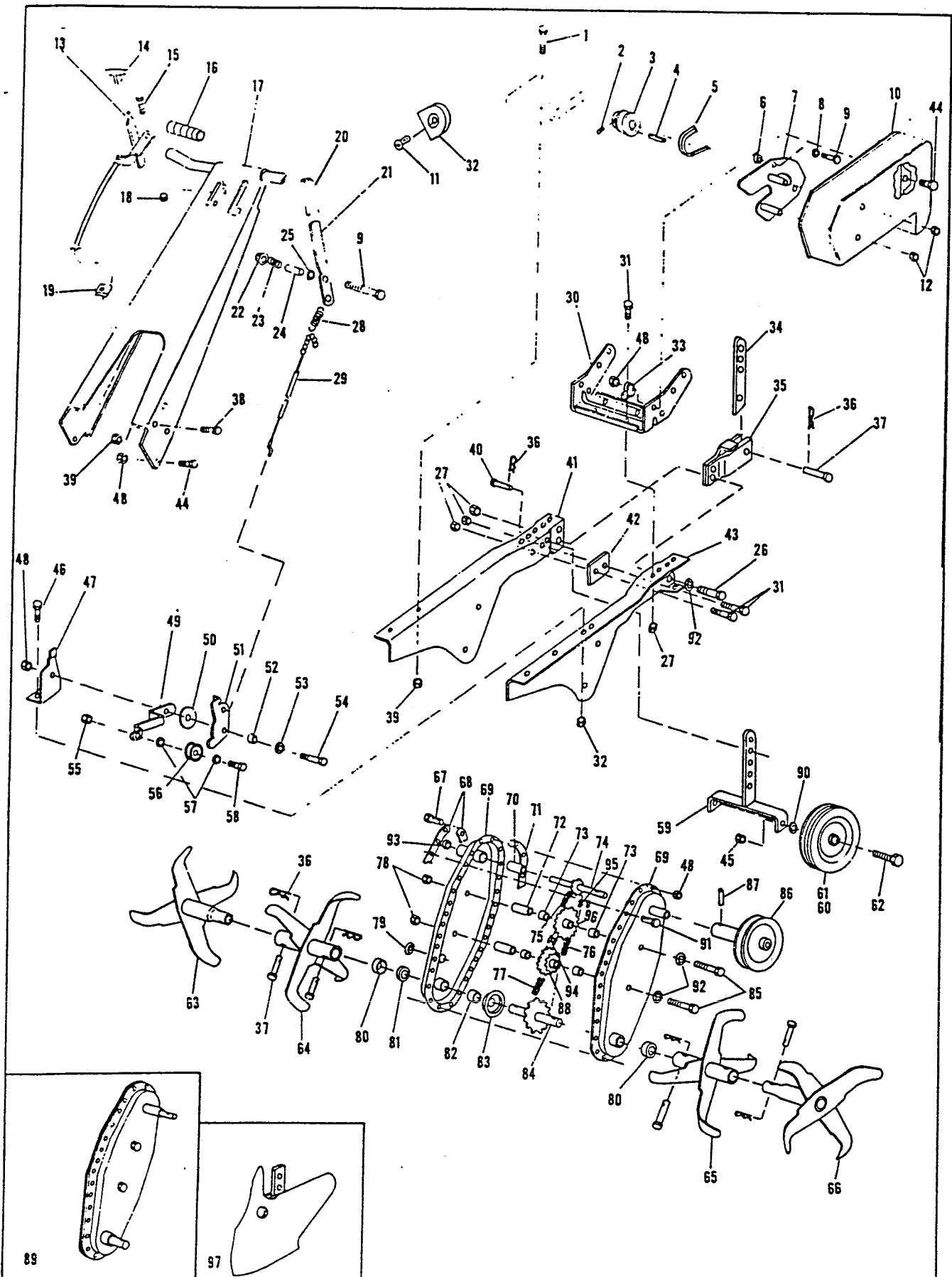

**MODEL: 53C
5 HP ROTARY TILLER**

PARTS LIST

Ref. No.	Part No.	Description	Ref. No.	Part No.	Description
1	18-43	Bolt - Hex 5/16-18 x 1-1/2	51	22-117	Plate - Idler Pivot
2	20-297	Set Screw	52	26-103	Spacer
3	105-98	Pulley - Engine	53	21-74	Washer 5/16
4	16-7	Key	54	20-46	Bolt - Hex 1/4-20 x 1
5	107-38	Belt	55	19-111	Nut - Locking 3/8-16 Jam
6	26-129	Spacer	56	105-87	Pulley Assembly - Idler
7	22-126	Plate Assembly - Belt Guide	57	21-202	Washer - Flat
8	21-14	Washer - Lock	58	20-67	Bolt - Hex 3/8-16 x 1
9	18-44	Bolt - 1/4-20 x 1-3/4	59	7-384	Wheel Bracket Assembly
10	10-270	Guard - Belt	60	3-211	Wheel - Lug Tread R.H.
11	20-334	Screw - Muffler Deflector	61	3-212	Wheel - Lug Tread L.H.
12	19-194	Nut - Flange 1/4-20	62	20-360	Bolt - Shoulder 3/8-16
13	8-85	Control - Throttle	63	84-90	Tine Assembly - L.H. Outer
14	46-36	Knob - Black	64	84-88	Tine Assembly - L.H. Inner
15	20-282	Screw - Hex 10-24 x 1/2	65	84-89	Tine Assembly - R.H. Inner
16	5-5	Grip	66	84-91	Tine Assembly - R.H. Outer
17	41-214	Panel Assembly	67	20-145	Bolt - Hex 1/4-20 x 1/2
18	19-1	Nut - Keps 10-24	68	112-48	Strap - Nut Plate
19	17-131	Clip - Tinnerman	69	128-42	Weld Assembly - Transmission
20	56-18	Tip - Lever	70	11-156	Bearing - Input
21	108-67	Lever	71	58-17	Gasket - Transmission Housing
22	19-139	Nut - Flange 1/4-20	72	13-15	Sleeve
23	76-104	Spring	73	11-155	Bearing
24	26-24	Spacer	74	102-144	Shaft Assembly - Input
25	21-113	Washer - Curved	75	110-49	Chain - Roller No. 35
26	20-157	Bolt - 3/8-16 x 1-1/4	76	110-50	Chain - Roller No. 420
27	19-197	Nut - Twin Whizlock	77	110-51	Chain - Roller No. 50
28	76-111	Spring - Cable	78	19-147	Nut - Keps 3/8-16
29	47-608	Cable - Control	79	114-24	Plug - Oil Fill
30	164-1	Channel - Handle Support	80	59-19	Cover - Tine Hub Seal
31	20-307	Bolt - Whizlock 3/8-16 x 1	81	74-15	Seal - Output Shaft
32	59-23	Deflector - Muffler	82	11-18	Bearing
33	17-155	Clamp	83	26-122	Spacer - Tine Shaft
34	136-11	Drag Bar	84	102-147	Shaft Assembly - Output
35	7-518	Drag Bracket Assembly	85	20-303	Bolt - 3/8-16 x 2-3/4
36	28-17	Hairpin Cotter	86	105-99	Pulley - Transmission
37	28-6	Pin - 3/8 x 1-5/8 Clevis	87	28-88	Pin - Roll
38	18-5	Bolt - Hex 5/16-18 x 5/8	88	135-45	Sprocket Assembly - Lower
39	19-118	Nut - Locking 5/16-18	89	128-43	Transmission Assembly
40	28-117	Pin - Clevis	90	21-33	Washer - 3/8 Flat
41	163-5	Beam - Main Support R.H.	91	20-305	Bolt - 1/4-20 x 5/8 Thread Forming
42	26-123	Spacer - Main Support Beam	92	21-207	Washer - 3/8 T-Lock
43	163-6	Beam - Main Support L.H.	93	74-29	Seal - Input Shaft
44	18-3	Bolt - 1/4-20 x 5/8	94	110-31	Master Link - No. 420
45	19-119	Nut - Eslock 3/8-16	95	110-11	Master Link - No. 35
46	18-3	Bolt - Hex 5/16-18 x 3/4	96	135-47	Sprocket Assembly - Upper
47	7-389	Bracket - Idler Mounting	OPTIONAL ACCESSORY		
48	19-117	Nut - Locking 1/4-20	97	23-54	Furrowing Kit
49	79-164	Arm - Forward Idler			
50	21-158	Washer - Flat			