

**MODEL: APCM203P/5L**  
**20" CUT 3 SPEED SELF-PROPELLED CONVERTIBLE MULCHING ROTARY MOWER**  
 Use Grass Catcher Model: APMM-GC  
 Grass Catcher: P/N 397040  
 Repl. Bag: P/N 161284

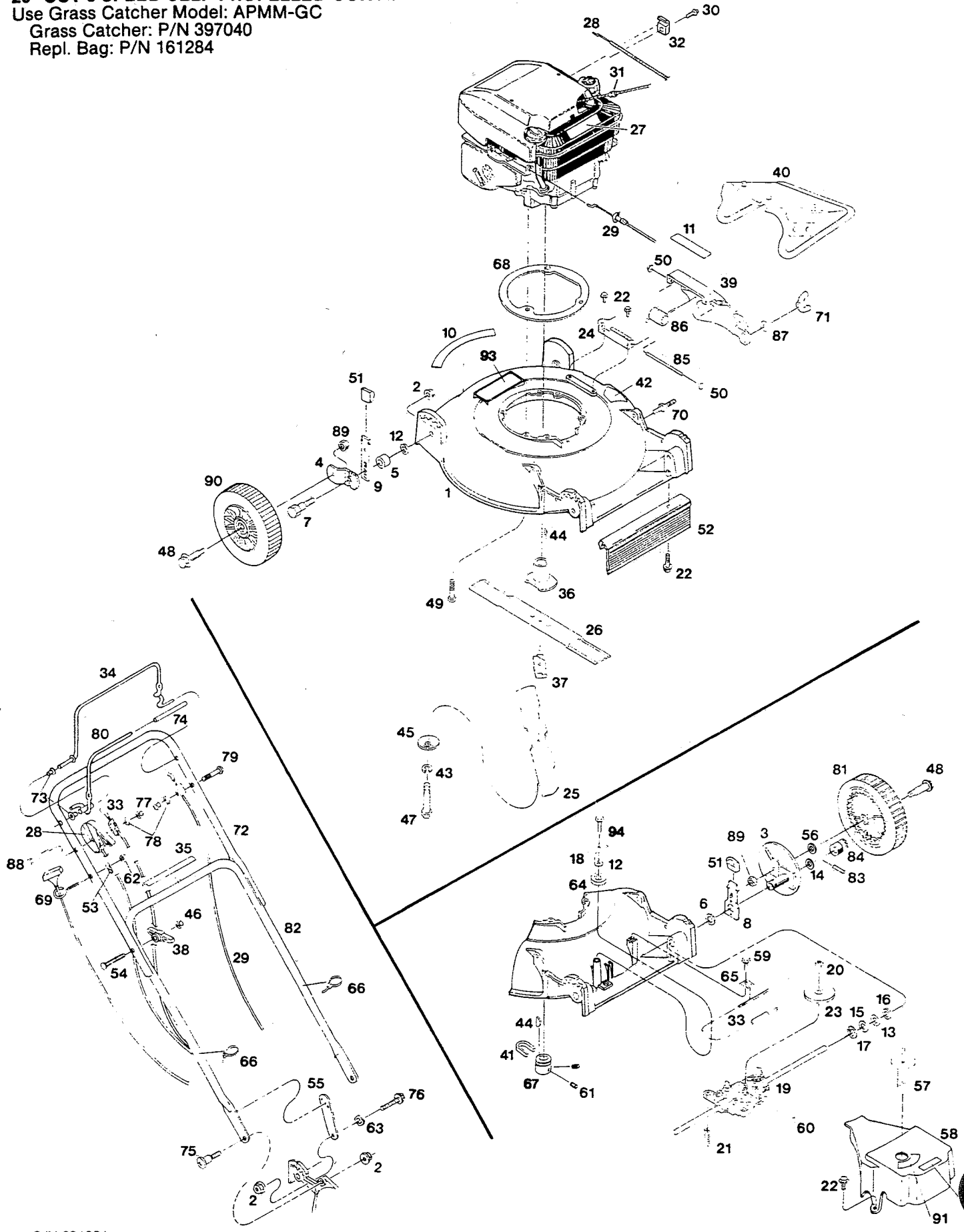

S/N 231831  
 P/L 082481  
 O/M 082574  
 E/M 589430

**MODEL: APCM203P/5L**  
**20" CUT 3 SPEED SELF-PROPELLED CONVERTIBLE MULCHING ROTARY MOWER**  
 Use Grass Catcher Model: APMM-GC  
 Grass Catcher: P/N 397040  
 Repl. Bag: P/N 161284

INDEX NO.	PART NO.	DESCRIPTION	INDEX NO.	PART NO.	DESCRIPTION
1	094915	Deck - 20" red 3 spd.	48	382879	Bolt - wheel
2	159236	Nut - 5/16-18 flg. lock	49	382881	bolt - 3/8-16 x 1-3/4" HHCS Gr. 5
3	589354	Drive wheel support ass'y	50	452128	Nut - 1/4 push-on
4	586794	Wheel arm	51	579717	Plastic tip - height adjuster
5	581274	Spacer - front hgt. adj.	52	579730	Trailing shield - plastic
6	581477	Spacer - rear hgt. adj.	53	580335	Washer
7	581490	Bolt - height adjuster	54	581463	Bolt - handle
8	588450	Setting lever assy L.H. rear	55	581507	Handle support
	588449	Setting lever assy R.H. rear	56	581584	Washer - 3/8" flat
9	588451	Setting lever assy. R.H. front	57	115394	Shift knob - plastic
	588452	Setting lever assy. L.H. front	58	115386	Drive cover 3 spd.
10	799562	Decal - logo	59	158089	Screw - 1/4-20 x 1/2" hex hd. tap
11	799506	Decal - danger mulch cover	60	583436	Key - transmission
12	715185	Washer - 5/16" flat	61	583085	Set screw 1/4-20 x 3/8"
13	579094	Washer - shim	62	583166	Nut - 1/4-20 lock
14	580632	Washer - 9/16" flat	63	583302	Washer
15	581005	Washer - 9/16" flat	64	086702	Pulley - 1 1/4" dia.
16	583308	Washer - 9/16" wave	65	586626	Clamp - drive cable
17	583355	E-ring	66	587059	Cable tie
18	096305	Retainer bracket	67	095060	Drive pulley
19	176792	Transmission - 3 spd.	68	587233	Engine ring - red
20	589368	Nut - 10mm lock	69	587287	Eyebolt - 1/4-20
21	589468	Spring - compression	70	587992	Stud - 1/4-20 x 3/4"
22	583021	Screw - 1/4-20 x 3/4" hes hd. tap	71	587998	Wing nut - 1/4-20 nylon insert
23	589376	Pulley - transmission	72	588434	Handle - upper
24	095003	Bracket - hinge	73	588463	Bushing - drive bail
25	031420	Blade - 20"	74	588474	Sleeve - drive bail
26	031421	Blade - recut 20"	75	588491	Bolt - handle mtg.
27	799503	Decal - blade warning	76	588499	Bolt - handle supt.
28	052951	Control - throttle w/cable	77	310052	Nut - 1/4-20 hex
29	052969	Cable - engine/blade control	78	588515	Washer - 1/4" star
30	150623	Screw - #10-16 x 5/8" tap	79	588519	Screw - 1/4-20 x 1-1/2" truss hd.
31	152074	Rope stop	80	588620	Bail - ground drive control
32	157552	Cable clamp	81	588709	Wheel - 8" power propelled
33	053043	Cable - traction control	82	588807	Handle - lower
34	094375	Bail - engine/blade control	83	589363	Drive pin
35	715557	Decal - starting instructions	84	589366	Pinion R.H. 3 spd.
36	094906	Adapter - blade		589365	Pinion L.H. 3 spd.
37	094911	Spacer - blade	85	604081	Rod hinge
38	113589	Wing nut - plastic	86	604082	Spring - mulch cover
39	115329	Cover - mulch 20"	87	615690	Washer - 1/4" flat
40	115417	Chute deflector assembly	88	615799	Bolt - 1/4-20 x 2-1/2" HHCS
41	178855	V-belt	89	715524	Nut - 3/8-16 jam lock
42	587522	Decal - CPSC danger	90	588697	Wheel - 8" front
43	156919	Washer - 3/8" lock H.D.	91	799411	Decal - 3 spd. shift inst.
44	162636	Key-woodruff #61	92	799437	Decal - 3 spd. belt cover
45	164681	Washer - 3/8" conical	93	799564	Decal - mulcher
46	310045	Nut - 5/16-18 hex	94	154294	Screw - 1/4-20 x 1" hex hd. tap
47	382846	Bolt - 3/8-24 x 3-1/2" HHCS Gr. 8			

- When servicing this unit use only genuine General Power OEM replacement parts that are specifically designed and engineered for this particular model.
- Do not operate unit unless all parts are properly attached and in good working order.
- Parts are right or left hand as viewed from the operator's position.
- Specifications are subject to change without notice.

S/N 231831  
 P/L 082481  
 O/M 082574  
 E/M 589430