

MODEL HCM20P/5.5GESM
5.5 hp 20" Cut Self-Propelled Electric-Start Convertible Mulching Mower
Uses Grass Catcher Model HMM-GC

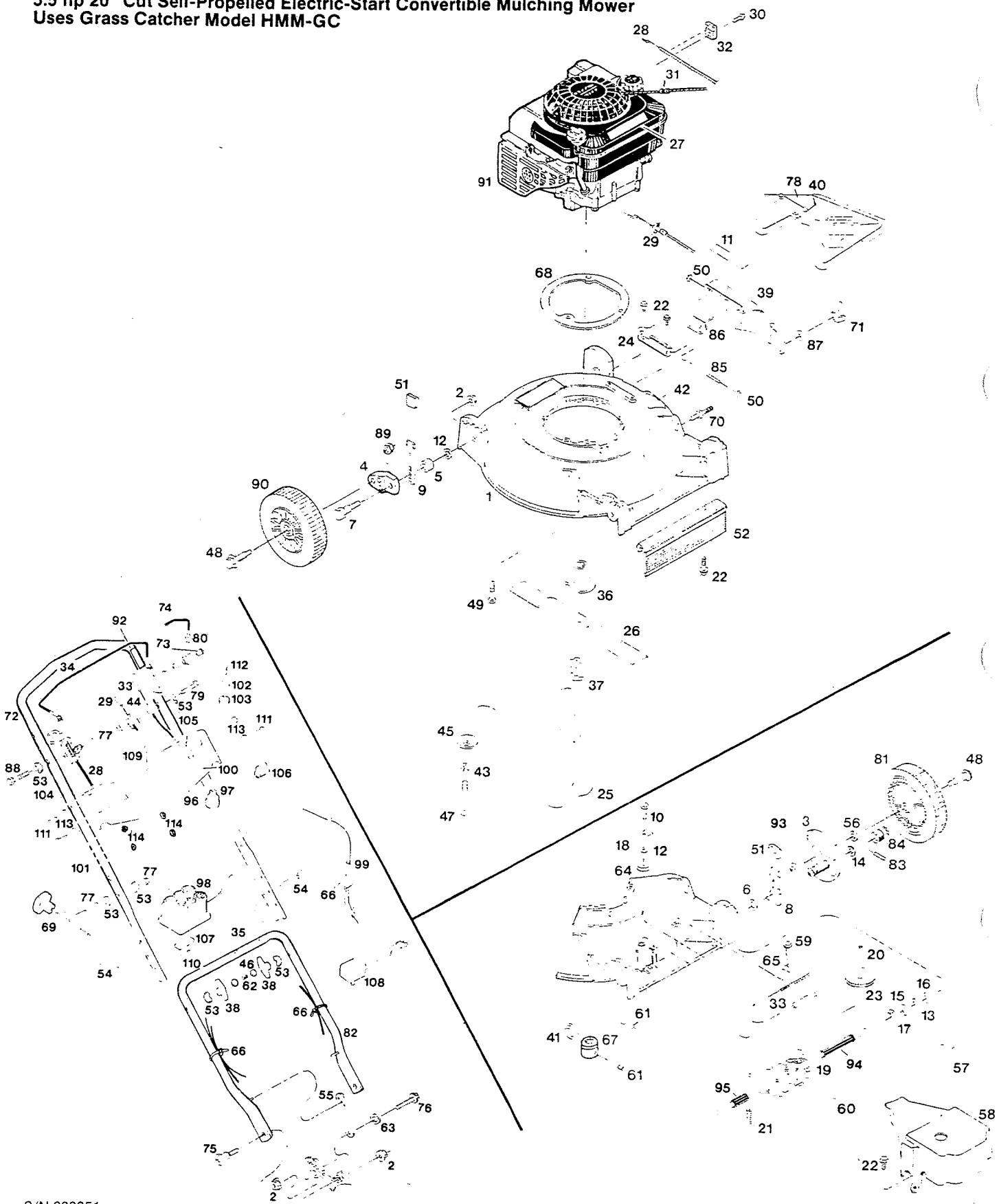

S/N 239951
P/L 082738
O/M 082641
E/M 082690

MODEL HCM20P/5.5GEM

**5.5 hp 20" Cut Self-Propelled Electric-Start Convertible Mulching Mower
Uses Grass Catcher Model HMM-GC**

INDEX NO.	PART NO.	DESCRIPTION	INDEX NO.	PART NO.	DESCRIPTION
1	031450	Deck - 20"	58	115386	Drive cover 3 spd.
2	159236	Nut - 5/16-18 flg. lock	59	158089	Screw - 1/4-20 x 1/2" hex hd. tap
3	095300	Drive wheel support ass'y	60	583436	Key - transmission pulley
4	031455	Wheel arm - blk	61	583085	Set screw 1/4-20 x 3/8"
5	581274	Spacer - front hgt. adj.	62	110064	Cap - bolt end, plastic
6	581477	Spacer - rear hgt. adj.	63	583302	Washer - 5/16 wave
7	581490	Bolt - height adjuster	64	086702	Pulley - 1/4" dia.
8	588449	Setting lever assy R.H. rear	65	586626	Clamp - drive cable
	588450	Setting lever assy L.H. rear	66	587059	Cable tie
9	588451	Setting lever assy. R.H. front	67	095218	Drive pulley
	588452	Setting lever assy. L.H. front	68	588984	Engine ring
10	154294	Screw - 1/4-20 x 1 hex hd. tap	69	152371	Eyebolt - 1/4-20
11	799505	Decal - danger mulch cover	70	587992	Stud - 1/4-20 x 3/4"
12	715185	Washer - 5/16" flat	71	587998	Wing nut - 1/4-20 nylon insert
13	579094	Washer - shim	72	095241	Handle - upper
14	580632	Washer - 9/16" flat	73	588463	Bushing - drive bail
15	581005	Washer - 9/16" flat	74	588474	Sleeve - drive bail
16	583308	Washer - 9/16" wave	75	588491	Bolt - handle mtg.
17	583355	E-ring	76	588499	Bolt - handle supt.
18	096305	Retainer bracket	77	715037	Nut - 1/4-20 hex keps
19	176792	Transmission - 3 spd.	78	144063	Decal - DANGER
20	589368	Nut - 10mm lock	79	153874	Bolt - hex - 1/4-20 x 2-1/4
21	589468	Spring - compression	80	095202	Bail - ground drive control
22	583021	Screw - 1/4-20 x 3/4" hex hd. tap	81	588709	Wheel - 8" power propelled
23	589376	Pulley - transmission	82	588807	Handle - lower
24	095003	Bracket - hinge	83	589363	Drive pin
25	031420	Blade - 20"	84	589366	Pinion R.H. 3 spd.
26	031421	Blade - recut 20"		589365	Pinion L.H. 3 spd.
27	009415	Decal - blade warning	85	604081	Rod hinge
28	053049	Control - throttle w/cable	86	604082	Spring - mulch cover
29	053048	Cable - engine/blade control	87	615690	Washer - 1/4" flat
30	166640	Screw - #10-16 x 5/8" tap	88	450379	Bolt - 1/4-20 x 1-3/4
31	152074	Rope stop	89	715391	Nut - 3/8-16 hex
32	157552	Cable clamp	90	588697	Wheel - 8"
33	053050	Cable - traction control	91	*	Engine
34	095200	Bail - engine/blade control	92	794412	Decal - engage/disengage
35	799599	Decal - starting instructions	93	156406	Nut - hex 3/8-16 flange lock
36	095217	Adapter - blade with key	94	115463	Cover - drive shaft 3-7/8
37	094911	Spacer - blade	95	115464	Cover - drive shaft 1-3/4
38	113589	Wing nut - plastic	96	023789	Panel - handle
39	115329	Cover - mulch 20"	97	050252	Switch - ignition
40	115360	Chute deflector assembly	98	134601	Battery - 12 volt
41	178855	V-belt	99	138743	Wiring Harness
42	143115	Decal - CPSC danger	100	144089	Decal - ignition
43	156919	Washer - 3/8" lock H.D.	101	147322	Decal - aux. rope start
44	115337	Spacer - cable mount	102	310102	Nut - hex 5/8-32
45	164681	Washer - 3/8" conical	103	311241	Washer - lock 5/8 int. tooth
46	310045	Nut - 5/16-18 hex	104	716761	Decal - electric start instr.
47	382846	Bolt - 3/8-24 x 3-1/2" HHCS Gr. 8	105	716779	Decal - danger elect. start
48	382889	Bolt - wheel	106	819714	Clip Wiring Press-on
49	382881	Bolt - 3/8-16 x 1-3/4" HHCS Gr. 5	107	101246	Plate - Reinforcing
50	452128	Nut - 1/4 push-on	108	132571	Battery Charger
51	579717	Plastic tip - height adjuster	109	151886	Screw - machine rd. #8-32 x 3-1/4
52	115468	Trailing shield - plastic	110	151894	Locknut - hex #8-32
53	150201	Washer - 5/16 curved	111	156836	Bolt - #10-24 x 1-1/8
54	151936	Bolt - handle	112	304352	Keys - ignition
55	095176	Handle support	113	715136	Washer - #10 flat
56	581584	Washer - 3/8" flat	114	715334	Nut - #10-24 keps
57	115394	Shift knob - plastic			

* Contact engine manufacturer's authorized service dealer for parts and warranty

S/N 239951
P/L 082738
O/M 082641
E/M 082690