

**82900 to 82997**

## **Illustrated Parts List**

**MODEL SERIES**

# **82900 to 82997**

TYPE NUMBERS

0010 to 0045

0110 to 0321

**TO FIND**

**THE CORRECT NUMBER OF THE PART YOU NEED:**

**FOLLOW THE INSTRUCTIONS BELOW.**

- A. Refer to Engine Model, Type and Code Number (formerly Serial Number) that is stamped on the blower housing or name plate of engine. Engine type numbers such as 0137 01 are listed herein only as 0137. The two digits (01 or 02, etc.) to the right of the space are not needed for parts identification. Then use the Illustrated Parts List covering these Model Series.
- B. Refer to Illustrated Parts section and compare the old part with illustration. The number on the illustration is the Reference Number. Assemblies include all parts shown in frames. All parts shown in assembly frames on which individual reference numbers are given can be purchased separately.
- C. After the Reference Number has been identified, refer to the Numerical Parts List, where Reference and Master Part Numbers are listed. **THE MASTER PART IS USED ON ALL TYPE NUMBERS EXCEPT THOSE TYPE NUMBERS UNDER "NOTE"**.
- D. If a "Note" appears below the Master Part Number, this means that this part differs from the Master Part for certain types. If the Type Number is listed under "Note", order the part referred to.
- E. If the Engine Type Number does not appear after any part number listed under "Note", use the Master Part Number.
- F. For Type Numbers higher than those covered by this book, please refer to the factory if you are unable to identify the part by comparison.



# 82900 to 82997

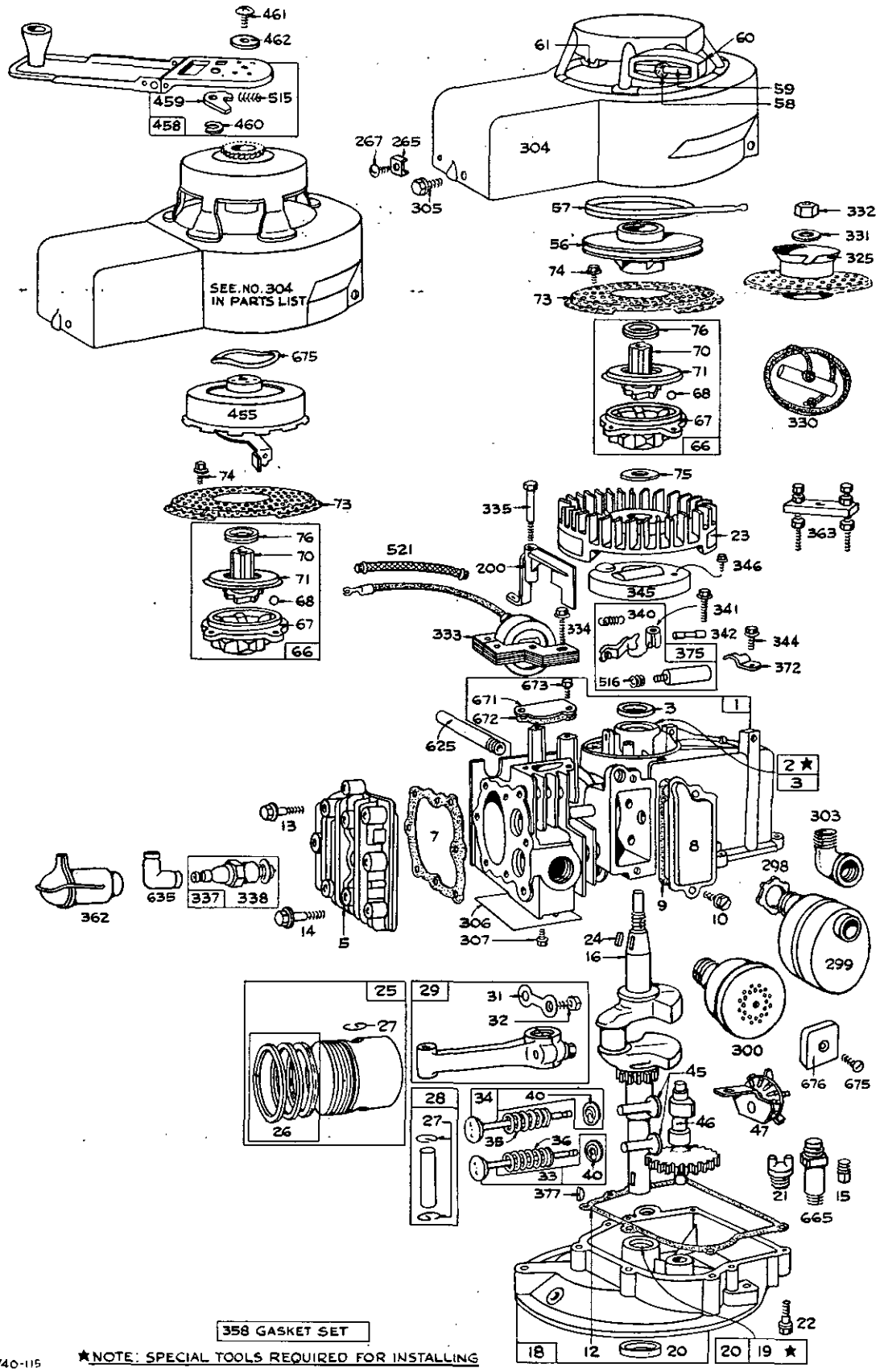

358 GASKET SET

3740-115

★NOTE: SPECIAL TOOLS REQUIRED FOR INSTALLING

Assemblies include all parts shown in frames

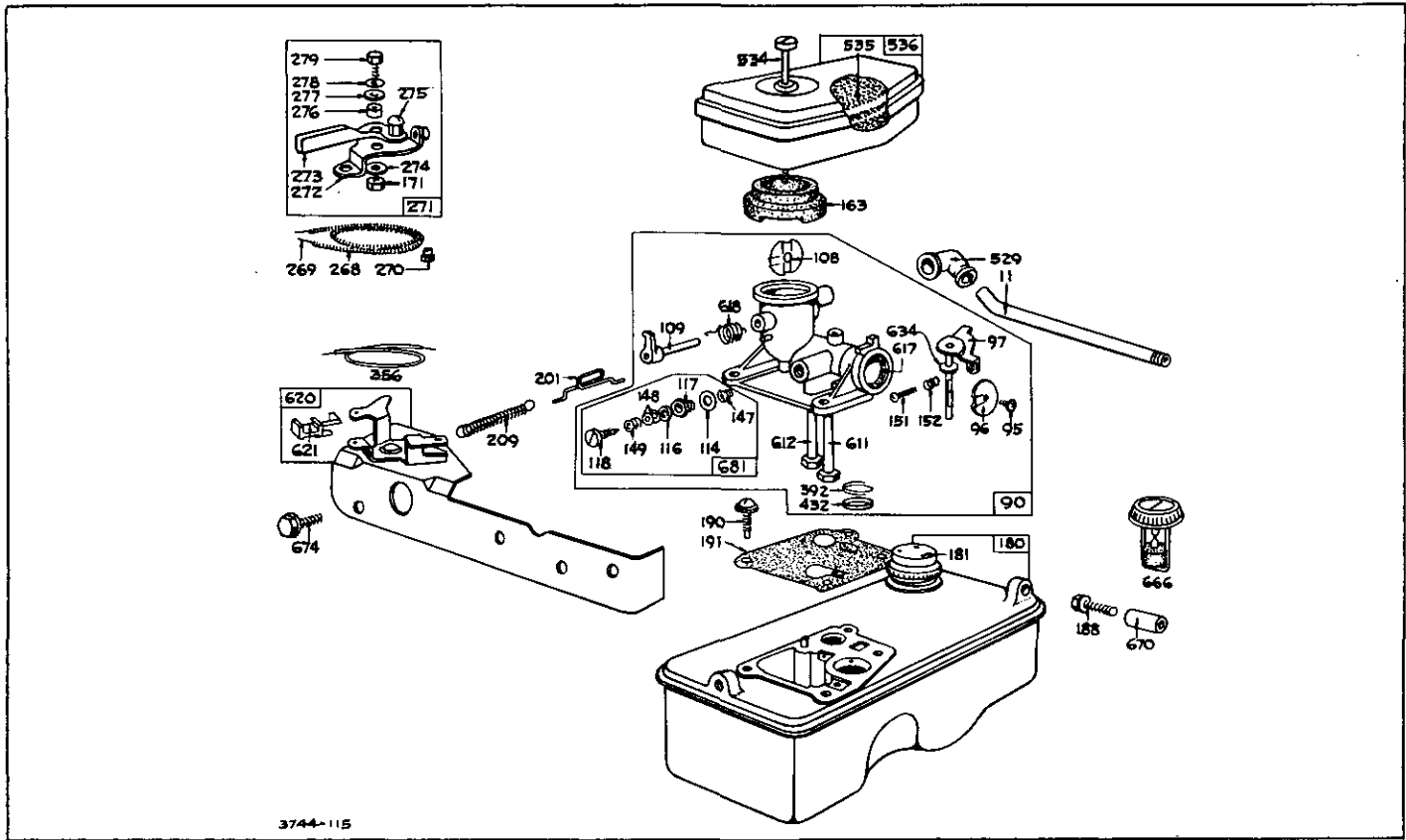

3744-115

REF. NO.	PART NO.	DESCRIPTION	REF. NO.	PART NO.	DESCRIPTION	REF. NO.	PART NO.	DESCRIPTION
1	298565	Cylinder Assembly <b>Note:</b> 298712 Cylinder Assy. Used on type No. 0231.	15	91084	Plug—Oil Drain <b>Note:</b> 92738 Plug—Oil Drain Used on type No. 0231. 93418 Plug—Oil Drain (Socket Head) Used on type Nos. 0028, 0135, 0151, 0157, 0165, 0172, 0176, 0180, 0182, 0184, 0190, 0199, 0202, 0205, 0220, 0223, 0228, 0229, 0235, 0236, 0237, 0241, 0243, 0256, 0265, 0285, 0291, 0299, 0310, 0314.			0224, 0236, 0238, 0251, 0267, 0273, 0274, 0279, 0294, 0298, 0307, 0308, 0311, 0313.
2	293708	Bushing—Cylinder <b>Note:</b> Requires special tools for installation.	16	260124	Crankshaft <b>Note:</b> 260091 Crankshaft Used on type No. 0110. 260096 Crankshaft Used on type Nos. 0017, 0018, 0031, 0116, 0121, 0144, 0149, 0153, 0175, 0188, 0189, 0193, 0201, 0206, 0209, 0215, 0216,			<b>260097</b> Crankshaft Used on type Nos. 0023, 0117, 0122, 0132, 0157, 0212, 0218, 0240, 0268, 0283, 0289, 0303, 0304, 0312, 0320. <b>260098</b> Crankshaft Used on type Nos. 0019, 0020, 0118, 0123, 0147, 0162, 0173, 0176, 0180, 0205, 0214, 0221, 0222, 0234, 0237, 0245, 0260, 0265, 0280, 0310, 0314, 0315, 0319. <b>260099</b> Crankshaft Uses: <b>220708</b> Shim— Crankshaft, Thrust Used on type Nos. 0040,
3	89660	Seal—Oil						
5	210812	Head—Cylinder						
7	*27670	Gasket—Cylinder Head						
8	298383	Breather—Valve Chamber						
9	*270239	Gasket—Valve Cover						
10	93394	Screw—Breather Mtg. Sem						
11	230802	Tube—Breather						
12	*27586	Gasket—Crankcase— .015" thick (Standard)						
	*27617	Gasket—Crankcase— .005" thick						
	*27618	Gasket—Crankcase— .009" thick						
13	93111	Screw—Cylinder Head (1-15/16" long)						
14	93113	Screw—Cylinder Head (2-5/16" long)						

\* Included in Gasket Set — Part No. 298588

# 82900 to 82997

REF. NO.	PART NO.	DESCRIPTION	REF. NO.	PART NO.	DESCRIPTION	REF. NO.	PART NO.	DESCRIPTION
		0041, 0042, 0125, 0126, 0161, 0183, 0194, 0207, 0217, 0249, 0252, 0261, 0262, 0287, 0302, 0306, 0309.			Used on type Nos. 0180, 0185, 0186, 0198, 0271, 0272.			0318, 0319, 0320.
		<b>260204</b> Crankshaft Used on type No. 0293.			<b>298280</b> Sump—Oil Used on all Model 82992, 82996 Series engines, <b>except type Nos. 0040, 0041, 0044</b> which use Part No. <b>294231</b> Sump.	<b>24</b>	<b>61760</b>	Key—Flywheel
		<b>260224</b> Crankshaft Uses: <b>220708</b> Shim—Crankshaft, Thrust Used on type Nos. 0043, 0044, 0143, 0145, 0146, 0148, 0152, 0187, 0197, 0211, 0248, 0254, 0303, 0317.			<b>298359</b> Sump—Oil Used on type No. 0197.	<b>25</b>	<b>295587</b>	Piston Assy.—Standard
		<b>260235</b> Crankshaft Used on type Nos. 0160, 0182, 0231, 0244, 0288, 0300, 0318.			<b>298727</b> Sump—Oil Used on type No. 0204.		<b>295588</b>	Piston Assembly—.010" O.S.
		<b>260319</b> Crankshaft Used on type Nos. 0136, 0208, 0277.	<b>19</b>	<b>293709</b>	<b>298841</b> Bushing—Oil Sump <b>Note:</b> Requires special tools for installation.		<b>295589</b>	Piston Assembly—.020" O.S.
		<b>260370</b> Crankshaft Used on type Nos. 0029, 0133.			<b>291841</b> Seal—Oil <b>Note:</b> <b>294167</b> Seal—Oil Used on type No. 0204.	<b>26</b>	<b>294232</b>	Ring Set—Standard Piston Consists of: <b>210471</b> Ring, Piston, Compression, Top, Std. <b>210472</b> Ring, Piston, Compression, Center, Std. <b>210473</b> Ring, Piston, Oil, Standard
		<b>260400</b> Crankshaft Used on type No. 0033.	<b>20</b>		<b>294167</b> Seal—Oil (Crankshaft—P. T. O. Side)		<b>294224</b>	Ring Set—.010" O.S. Piston Consists of: <b>210490</b> Ring, Piston, Compression, Top, .010" O.S. <b>210489</b> Ring, Piston, Compression, Center, .010" O.S. <b>210491</b> Ring, Piston, Oil, .010" O.S.
		<b>260402</b> Crankshaft Used on type No. 0239.			<b>298041</b> Seal—Oil (1/2" Auxiliary Drive Shaft)		<b>294225</b>	Ring Set—.020" O.S. Piston Consists of: <b>210493</b> Ring, Piston, Top, .020" O.S. <b>210492</b> Ring, Piston, Compression, Center, .020" O.S. <b>210494</b> Ring, Piston, Oil, .020" O.S.
		<b>260411</b> Crankshaft Used on type Nos. 0028, 0241.			Used on all Model 82992, 82996 Series engines <b>except type Nos. 0040, 0041, 0044</b> which use: <b>294167</b> Seal—Oil (Crankshaft—P. T. O. Side)			<b>210493</b> Ring, Piston, Top, .020" O.S. <b>210492</b> Ring, Piston, Compression, Center, .020" O.S. <b>210494</b> Ring, Piston, Oil, .020" O.S.
		<b>260601</b> Crankshaft Used on type Nos. 0170, 0171.	<b>21</b>	<b>66768</b>	<b>294160</b> Seal—Oil 3/4" Auxiliary Drive Shaft		<b>294226</b>	Ring Set—.030" O.S. Piston Consists of: <b>210496</b> Ring, Piston, Compression, Top, .030" O.S. <b>210495</b> Ring, Piston, Compression, Center, .030" O.S. <b>210497</b> Ring, Piston, Oil, .030" O.S.
		<b>260670</b> Crankshaft Used on type Nos. 0021, 0022, 0032, 0137, 0138, 0139, 0140, 0141.	<b>22</b>	<b>93032</b>	<b>296884</b> Plug—Oil Filler			<b>210497</b> Ring, Piston, Oil, .030" O.S.
		<b>260834</b> Crankshaft Used on type Nos. 0200, 0203, 0204, 0210.	<b>23</b>	<b>297949</b>	<b>Note:</b> <b>296884</b> Flywheel—Magneto Used on type Nos. 0015, 0019, 0020, 0023, 0136, 0147, 0157, 0165, 0169, 0173, 0176, 0178, 0180, 0183, 0186, 0197, 0198, 0203, 0204, 0205, 0206, 0208, 0213, 0219, 0220, 0224, 0231, 0234, 0237, 0252, 0257, 0260, 0265, 0269, 0273, 0277, 0278, 0279, 0285, 0286, 0290, 0292, 0298, 0300, 0301, 0308, 0310, 0311, 0314,	<b>27</b>	<b>26026</b>	Lock—Piston Pin
<b>18</b>	<b>293512</b>	Sump—Oil <b>Note:</b> <b>293597</b> Sump—Oil Used on type Nos. 0204, 0208, 0210, 0224, 0237, 0265, 0277, 0298, 0314, 0319. <b>295041</b> Sump—Oil						

\* Included in Gasket Set — Part No. 298588

# 82900 to 82997

REF. NO.	PART NO.	DESCRIPTION	REF. NO.	PART NO.	DESCRIPTION	REF. NO.	PART NO.	DESCRIPTION		
28	291925	Pin Assembly—Piston—Standard			except type Nos. 0040, 0041, 0044 which use Part No. 210804 Cam Gear (3/4" Dia. P. T. O).	152	260575	Spring—Throttle Adjustment		
	291926	Pin Assembly—Piston—.005" O. S.				163	*270228	Gasket—Air Cleaner Mtg.		
29	294201	Rod Assembly—Connecting	47	294652	Oil Slinger Gear and Bracket	171	92129	Nut—Hex.—1/4-28		
31	220756	Lock—Connecting Rod Screw			<b>Note:</b> 294718 Oil Slinger Gear and Bracket	180	298465	Tank Assembly—Fuel		
32	92296	Screw—Connecting Rod			Used on type Nos. 0040, 0041, 0044.	181	298425	Cap—Fuel Tank		
33	296676	Valve—Exhaust	56	294088	Pulley—Rewind Starter	188	93444	Screw—Hex. Hd. Sem		
		<b>Note:</b> 26973 Valve—Exhaust Used on type Nos. 0166, 0210, 0271, 0275, 0276, 0303, 0317.	57	294303	Spring—Rewind Starter	190	93440	Screw—Fuel Tank Mtg.		
		260075 Valve—Exhaust, Stellite	58	66384	Rope—Rewind Starter—47-1/8" Long	191	*270253	Gasket and Diaphragm—Fuel Tank		
		Used on type No. 0231.			<b>Note:</b> If longer rope is needed, order No. 66514 and cut to required length.	200	68388	Blade—Governor		
34	296677	Valve—Intake	59	230228	Pin—Starter Rope	201	260821	Link—Governor		
		<b>Note:</b> 230101 Valve—Intake Used on type No. 0231.	60	66728	Grip—Starter Rope	209	260832	Spring—Governor		
35	260552	Spring—Intake Valve	61	66528	Bumper—Starter Pulley			<b>Note:</b> 260827 Spring—Governor (For 4000 to 4200 rpm top speed set—no load) Used on type Nos: 0028, 0129, 0131, 0136, 0153, 0154, 0155, 0167, 0168, 0169, 0170, 0171, 0173, 0174, 0175, 0176, 0180, 0186, 0190, 0197, 0198, 0199, 0200, 0201, 0203, 0204, 0205, 0209, 0211, 0213, 0234, 0235, 0237, 0241, 0244, 0245, 0256, 0265, 0273, 0274, 0285, 0287, 0291, 0295, 0296, 0299, 0306, 0308, 0309, 0316.		
36	26478	Spring—Exhaust Valve	66	298310	Clutch Assembly—Rewind and Wind-up Starter			260835 Spring—Governor (3200 to 3400 rpm top speed set—no load) Used on type Nos: 0133, 0135, 0142, 0144, 0145, 0146, 0149, 0151, 0158, 0159, 0160, 0161, 0164, 0172, 0182, 0183, 0184, 0206, 0208, 0210, 0212, 0231, 0239, 0246, 0249, 0251, 0252, 0253, 0259, 0260, 0267, 0275, 0276, 0278, 0279, 0283, 0286, 0288, 0289, 0294, 0298, 0303, 0304, 0314, 0317.		
		<b>Note:</b> 26826 Spring—Exhaust Valve Used on type Nos. 0166, 0210, 0231, 0271, 0275, 0276, 0303, 0317.	67	211383	Housing—Starter Clutch			265	22372	Clamp—Casing
40	93312	Retainer—Valve Spring	68	63770	Ball—Clutch			267	93469	Screw—Clamp Mounting
		Used with valves with groove in stem.	70	298436	Ratchet—Rewind and Wind-up Starter			268	66986	Casing—Control Wire—48" Long
		<b>Note:</b> 23184 Retainer—Intake Valve Spring	71	221653	Washer—Clutch Retainer					<b>Note:</b> If longer casing is
		23187 Pin—Intake Valve Spring Retainer	73	221661	Screen—Rewind and Wind-up Starter					
		Used on type No. 0231.	74	93042	Screw—Rotating Screen Mounting Sem					
		292259 Rotocap—Exhaust Valve	75	220865	Washer—Spring					
		230126 Pin—Exhaust Valve Rotocap Retainer	76	68238	Washer—Ratchet Sealing					
		230127 Retainer—Exhaust Valve Rotocap	90	298567	Carburetor Assembly					
		Used on type Nos. 0166, 0210, 0231, 0271, 0275, 0276, 0303, 0317.	95	93385	Screw—Throttle Valve Mounting Sem					
45	230173	Tappet—Valve	96	211237	Valve—Throttle					
46	210453	Gear—Cam	97	298460	Shaft and Lever—Throttle Valve—Choke					
		<b>Note:</b> 211337 Gear—Cam (1/2" Dia. P. T. O.) Used on all Model 82992, 82996 Series engines	108	67778	Valve—Choke					
			109	67768	Shaft and Lever—Choke					
			114	66594	Gasket—Needle Valve Nut					
			116	65978	Packing—Needle Valve					
			117	230590	Nut—Needle Valve					
			118	23433	Valve—Needle					
			147	230591	Seat—Needle Valve					
			148	22235	Washer—Needle Valve					
			149	26336	Spring—Needle Valve					
			151	92634	Screw—Machine, Rd. Hd.—5-40 x 5/8"					

\* Included in Gasket Set — Part No. 298588

# 82900 to 82997

REF. NO.	PART NO.	DESCRIPTION	REF. NO.	PART NO.	DESCRIPTION	REF. NO.	PART NO.	DESCRIPTION
		needed, specify length in inches; if a shorter casing is needed order No. 66986 and cut to required length.			0174, 0179, 0185, 0187, 0203, 0204, 0209, 0213, 0215, 0238, 0247, 0248, 0278, 0279, 0287, 0292, 0299, 0307, 0309.	<b>335</b>	<b>93435</b>	Screw—Armature and Governor Blade Mounting Sem
<b>269</b>	<b>26099</b>	Wire—Control, 54" Long <b>Note:</b> If longer wire is needed, specify length in inches; if shorter wire is needed order No. 26099 and cut to required length.			<b>298602</b> Housing—Blower (For Rewind Starter) Used on type Nos. 0136, 0148, 0196, 0260, 0268, 0300, 0308, 0314.	<b>337</b>	<b>29693</b>	Plug—Spark (with gasket) <b>Note:</b> <b>293918</b> Plug—Spark (With Gasket) Used on type Nos. 0028, 0207, 0216, 0240, 0241, 0268.
<b>270</b>	<b>63426</b>	Locknut—Control Wire Casing			<b>298604</b> Housing—Blower (For Rewind Starter) Used on type Nos. 0021, 0137, 0139, 0152, 0164, 0177, 0217, 0218, 0241, 0275, 0296, 0315.	<b>338</b>	<b>29806</b>	Gasket—Spark Plug
<b>271</b>	<b>290568</b>	Lever Assembly—Control			<b>298606</b> Housing—Blower (For Rewind Starter) Used on type Nos. 0147, 0163, 0172, 0178, 0183, 0193, 0194, 0197, 0198, 0220, 0223, 0228, 0233, 0320.	<b>340</b>	<b>26018</b>	Spring—Breaker Arm
<b>272</b>	<b>290584</b>	Base—Control Lever			<b>298608</b> Housing—Blower (For Rewind Starter) Used on type No. 0297.	<b>341</b>	<b>93381</b>	Screw—Contact Finger Post Mounting Sem
<b>273</b>	<b>290642</b>	Lever—Control	<b>305</b>	<b>93479</b>	Screw—Blower Housing Mounting Sem	<b>342</b>	<b>65704</b>	Plunger—Breaker Point
<b>274</b>	<b>91237</b>	Washer—Lock— 1/4 x 3/32 x 5/64"	<b>306</b>	<b>220478</b>	Shield—Cylinder	<b>344</b>	<b>93042</b>	Screw—Condenser Clamp Mounting Sem
<b>275</b>	<b>92287</b>	Screw—Machine, Rd. Hd.—10-32 x 1/2"	<b>307</b>	<b>93042</b>	Screw—Cylinder Shield Mounting Sem	<b>345</b>	<b>220366</b>	Cover—Breaker Point and Condenser
<b>276</b>	<b>22834</b>	Washer—Spacer	<b>325</b>	<b>293959</b>	Starter Pulley with Screen <b>Note:</b> <b>298731</b> Starter Pulley with Screen Used on type Nos. 0265, 0298.	<b>346</b>	<b>93014</b>	Screw—Dust Cover Mounting Sem
<b>277</b>	<b>22368</b>	Washer—Control Lever	<b>330</b>	<b>29878</b>	Rope—Starter	<b>356</b>	<b>298479</b>	Wire—Ground
<b>278</b>	<b>22725</b>	Washer—Control Lever	<b>331</b>	<b>62577</b>	Washer—Flywheel <b>Note:</b> <b>220865</b> Washer—Flywheel Used on type Nos. 0265, 0298.	<b>358</b>	<b>298588</b>	Gasket Set
<b>279</b>	<b>92306</b>	Screw—Cap, Hex. Hd.— 1/4-28 x 5/8"	<b>332</b>	<b>91708</b>	Nut—Flywheel <b>Note:</b> <b>92284</b> Nut—Flywheel Used on type Nos. 0265, 0298.	<b>362</b>	<b>89742</b>	Shield—Spark Plug
<b>298</b>	<b>220859</b>	Locknut—Muffler <b>Note:</b> <b>91811</b> Locknut—Muffler Used on type No. 0291.	<b>333</b>	<b>298502</b>	Armature—Magneto	<b>363</b>	<b>19069</b>	Pulley—Flywheel (Optional Accessory)
<b>299</b>	<b>294441</b>	Muffler—Exhaust	<b>334</b>	<b>93381</b>	Screw—Armature Mounting Sem	<b>372</b>	<b>220477</b>	Clamp—Condenser
<b>300</b>	<b>298395</b>	Muffler—Exhaust <b>Note:</b> <b>89966</b> Muffler—Exhaust Used on type No. 0291.				<b>375</b>	<b>294628</b>	Breaker Points and Condenser Set <b>Note:</b> <b>299061</b> Ignition Kit Includes: <b>294628</b> Point Set <b>65704</b> Plunger <b>61760</b> Key—Flywheel
<b>303</b>	<b>91943</b>	Elbow—Exhaust, 90°, Street				<b>377</b>	<b>93065</b>	Key—Woodruff No. 505
<b>304</b>	<b>298568</b>	Housing—Blower (For Rewind Starter) <b>Note:</b> <b>298467</b> Housing—Blower (For Rope Starter) Used on Model 82901 Series. <b>298570</b> Housing—Blower (For Wind-up Starter) Used on Model 82906, 82996 Series. <b>298599</b> Housing—Blower (For Rewind Starter) Used on type Nos. 0016, 0018, 0020, 0022, 0029, 0041, 0132, 0138, 0162,				<b>392</b>	<b>260455</b>	Spring—Fuel Pump Diaphragm
						<b>432</b>	<b>221377</b>	Cap—Spring
						<b>455</b>	<b>297542</b>	Cup, Spring and Release Assembly
						<b>458</b>	<b>298431</b>	Handle Assembly—Cranking
						<b>459</b>	<b>221332</b>	Pawl—Ratchet
						<b>460</b>	<b>93272</b>	Retainer—Ratchet Pawl
						<b>461</b>	<b>93298</b>	Screw—Handle Mounting
						<b>462</b>	<b>221237</b>	Washer—Handle Mounting
						<b>515</b>	<b>260537</b>	Spring—Ratchet Pawl
						<b>516</b>	<b>260374</b>	Spring—Connector
						<b>521</b>	<b>297973</b>	Shielding—Ignition Cable
						<b>529</b>	<b>67838</b>	Grommet—Breather

\* Included in Gasket Set — Part No. 298588

# 82900 to 82997

REF. NO.	PART NO.	DESCRIPTION	REF. NO.	PART NO.	DESCRIPTION	REF. NO.	PART NO.	DESCRIPTION
534	93374	Screw—Air Cleaner			0166, 0173, 0176, 0182,	621	297472	Switch—Stop
535	270251	Element—Air Cleaner			0192, 0195, 0196, 0205,	625	230803	Tube—Fuel Intake
536	298566	Cleaner Assembly—Air			0208, 0224, 0234, 0235,	634	270167	Washer—Throttle Shaft (Felt)
611	297219	Pipe—Fuel (Long)			0241, 0243, 0244, 0249,	635	66538	Elbow—Spark Plug
612	296811	Pipe—Fuel (Short)			0253, 0256, 0260, 0264,	665	296768	Oil Minder
617	270248	Seal—Fuel Intake Tube			0266, 0267, 0270, 0271,	666	297073	Gauge—Fuel Level
618	260831	Spring—Choke Return			0272, 0274, 0277, 0283,	670	211412	Spacer—Fuel Tank
620	298468	Plate Assembly— Carburetor Control			0289, 0298, 0299, 0301, 0314, 0318, 0319.	671	221720	Cover—Intake Port
	<b>Note:</b>	<b>298469</b> Plate Assembly— Carburetor Control Used on type Nos. 0015, 0016, 0017, 0018, 0019, 0020, 0021, 0022, 0023, 0028, 0029, 0030, 0031, 0032, 0033, 0040, 0041, 0042, 0043, 0044, 0135,			<b>298652</b> Control Assembly Uses: <b>260846</b> Link— Control <b>93475</b> Screw <b>91122</b> Washer— Lock Used on type Nos. 0137, 0141, 0200, 0201.	672	270254	Gasket—Intake Port Cover
						673	93438	Screw—Intake Port Cover
						674	93447	Screw—Tank to Bracket
						675	93408	Washer—Starter Spring Housing Spring
						676	221643	Deflector—Muffler
						677	93378	Screw—Muffler Deflector
						681	299060	Needle Valve Kit