

K12111111A
312-3000

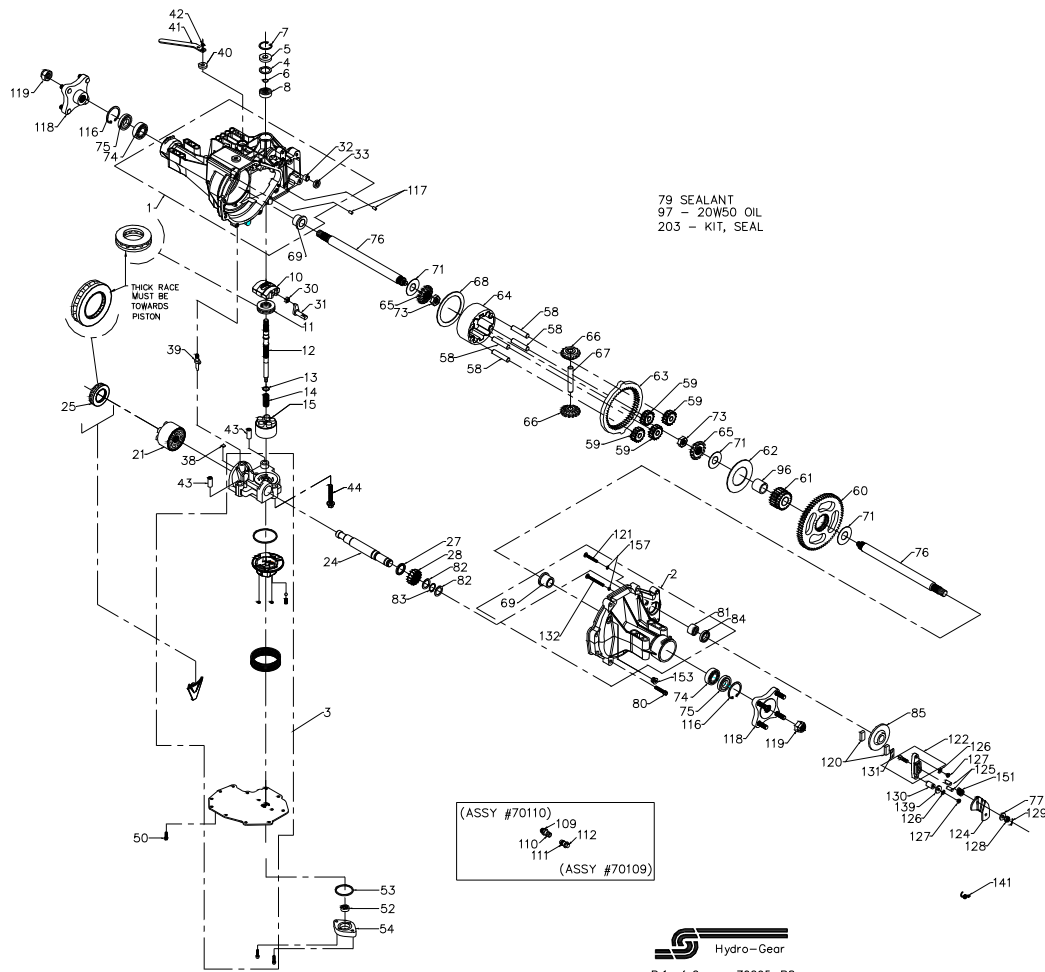

P.1 of 2. 70295-P8

K12111111A
312-3000

ITEM #	PART #	QTY	DESCRIPTION	ITEM #	PART #	QTY	DESCRIPTION	ITEM #	PART #	QTY	DESCRIPTION
1	70297	1	MAIN HOUSING ASSEMBLY	31	2003005	1	TRUNNION ARM	111	50217	1	VENT
		1	MAIN HOUSING	32	2003009	1	TRUNNION BUSHING	112	50216	1	CAP
		1	LIP SEAL	33	9008000-0126	1	SEAL, LIP 12 X 25 X 7	116	50859	2	RING, RETAINING
		1	FLANGE BEARING	38	70680	1	KIT, BYPASS PLATE	117	9004800-2506	2	STD HDLS PIN
		1	TRUNNION BUSHING	39	2003555	1	BYPASS ACTUATOR	118	70314	2	HUB ASSEMBLY
		2	CRADLE BEARING	40	45074	2	LIP SEAL	119	50863	2	NUT, HEX 3/4-16
2	70298	1	R.H. HOUSING ASSEMBLY	41	50929	1	BYPASS ARM	120	44132	2	PUCK, BRAKE
		1	R.H. HOUSING	42	44870	1	RETAINING RING	121	50874	1	RIB NECK BOLT 2"
		1	FLANGE BEARING	43	50002	2	PIN	122	50879	1	YOKE, BRAKE ASSEMBLY
		2	O RING	44	50016	3	SCREW	124	50936	1	ARM, BRAKE
		1	RIB NECK BOLT, 2"	49	50783	1	GASKET, LOWER	125	44127	2	PINS, BRAKE
		1	RIB NECK BOLT, 3"	50	50437	11	SCREW-SELF TAPPING	126	43177	2	LOCKWASHER, 1/4"
		1	NEEDLE BEARING (SCE1412)	52	50273	1	GEROTOR ASSEMBLY	127	43178	2	NUT, 1/4-20
		1	SEAL, LIP .875 X 1.38 X .25	53	9004101-1340	1	O-RING	128	44142	1	NUT, CASTLE
3	70439	1	KIT, MANIFOLD	54	50260	1	GEROTOR COVER	129	44101	1	COTTER PIN
		1	KIT, CENTER SECTION	55	70380	1	MANIFOLD FILTER KIT	130	23711	1	SPACER
		1	BEARING .50 X .60 X .50	56	50958	1	CHARGE MANIFOLD	131	44134	1	PUCK PLATE
		1	BUSHING .90 X 1.02 X .75	57	50796	1	RETAINER, MOTOR BEARING	132	50865	1	RIB NECK BOLT 3"
		1	PLATE, BYPASS	58	50776	4	PIN, CARRIER	139	44278	1	WASHER, 7/8OD X .265ID X .125 THK
		2	CHECK PLUG ASSEMBLY, .027	59	50763	1	15T PLANET GEAR	141	50884	1	SPRING, BRAKE ARM BIAS
		2	CAPSCREW M6X1-22	60	50646	1	67T SPUR GEAR	144	70361	1	MANIFOLD O-RING KIT
		1	COVER, LOWER	61	50645	1	21 TOOTH SUN GEAR	145	2000029	1	CHARGE RELIEF SPRING
		1	KIT, FILTER	62	50769	1	PLANET THRUST PLATE	146	50961	1	BALL
		1	MANIFOLD, CHARGE	63	50764	1	51T RING GEAR	151	50919	1	COMP. SPRING, BRAKE ANTI-DRAW
		1	RETAINER, MOTOR BEARING	64	50765	1	PLANETARY CARRIER	153	9005110-5600	1	PLUG, STRAIGHT THREAD
		1	O RING .103X2.987	65	50647	2	MITER GEAR, DIFF. (SPLINED)	156	50976	1	MANIFOLD O-RING
		1	SPRING, RELIEF	66	50648	2	MITER GEAR, DIFF.	157	50977	2	SCREW O-RING
		1	BALL 7/16	67	50766	1	SHAFT, DIFFERENTIAL	203	70492	1	KIT, SEAL
		2	O-RING .070X.239	68	50767	1	DIFF. THRUST PLATE			1	SEAL-LIP 15X5X37
4	2003018	1	SPACER	69	50768	2	FLANGE BEARING			1	SEAL-LIP 12X25X7
5	9008000-0128	1	SEAL-LIP	71	50788	3	WASHER 1.0 X 2.25 X .04			1	SEAL-LIP 10X25X7
6	2003016	1	WIRE RETAINING RING	73	50791	2	HEX JAM NUT, 5/8-18			1	O-RING .103X1.862
7	2003052	1	RETAINING RING	74	50771	2	BEARING, BALL 6205-1			2	SEAL 25X52X10
8	2003043	1	BALL BEARING	75	50772	2	SEAL 1 X 2.047 X .375			1	LIP SEAL (.875 I.D.X1.3 O.D. X.25)
10	2003087	1	VARIABLE SWASHPLATE	76	50825	2	SHAFT, AXLE			4	O-RING .070X.239
11	50551	1	THRUST BEARING 30 X 52 X 13	77	44130	1	WASHER			1	KIT, O-RING, MANIFOLD
12	50795	1	INPUT SHAFT	79	50928	9	SEALANT				
13	2003017	1	BLOCK THRUST WASHER	80	50868	1	TORX HEAD SCREW, 5/16-18				
14	2003014	1	LOCK SPRING	81	44752	1	NEEDLE BEARING (SCE1412)				
15	70331	1	10cc CYLINDER BLOCK ASSEMBLY	82	50777	2	WASHER				
		5	10cc CYLINDER BLOCK	83	50775	1	RETAINING RING				
		5	10cc PISTON	84	50773	1	LIP SEAL (.875 I.D.x1.30 D.x.25)				
		5	10cc PISTON SPRING	85	50779	1	BRAKE DISK				
		5	PISTON SEAT WASHER	96	50866	1	SLEEVE BEARING				
21	70082	1	21cc CYLINDER BLOCK ASSEMBLY	97		122 OZ	OIL-20W50				
		1	21cc CYLINDER BLOCK	109	50218	1	O-RING				
		7	PISTON SEAT WASHER	110	50219	1	FITTING				
		7	21cc PISTON								
		7	21cc PISTON SPRING								
24	50662	1	OUTPUT (MOTOR) SHAFT								
25	50552	1	THRUST BEARING 42 X 68 X 16								
27	50774	1	SPACER								
28	50661	1	16T PINION GEAR								
29	50975	2	CAPSCREW, M6 X 1-22								
30	2000015	1	SLOT GUIDE								

Hydro-Gear

P.2 of 2. 70295-P8