

033629
319-3000

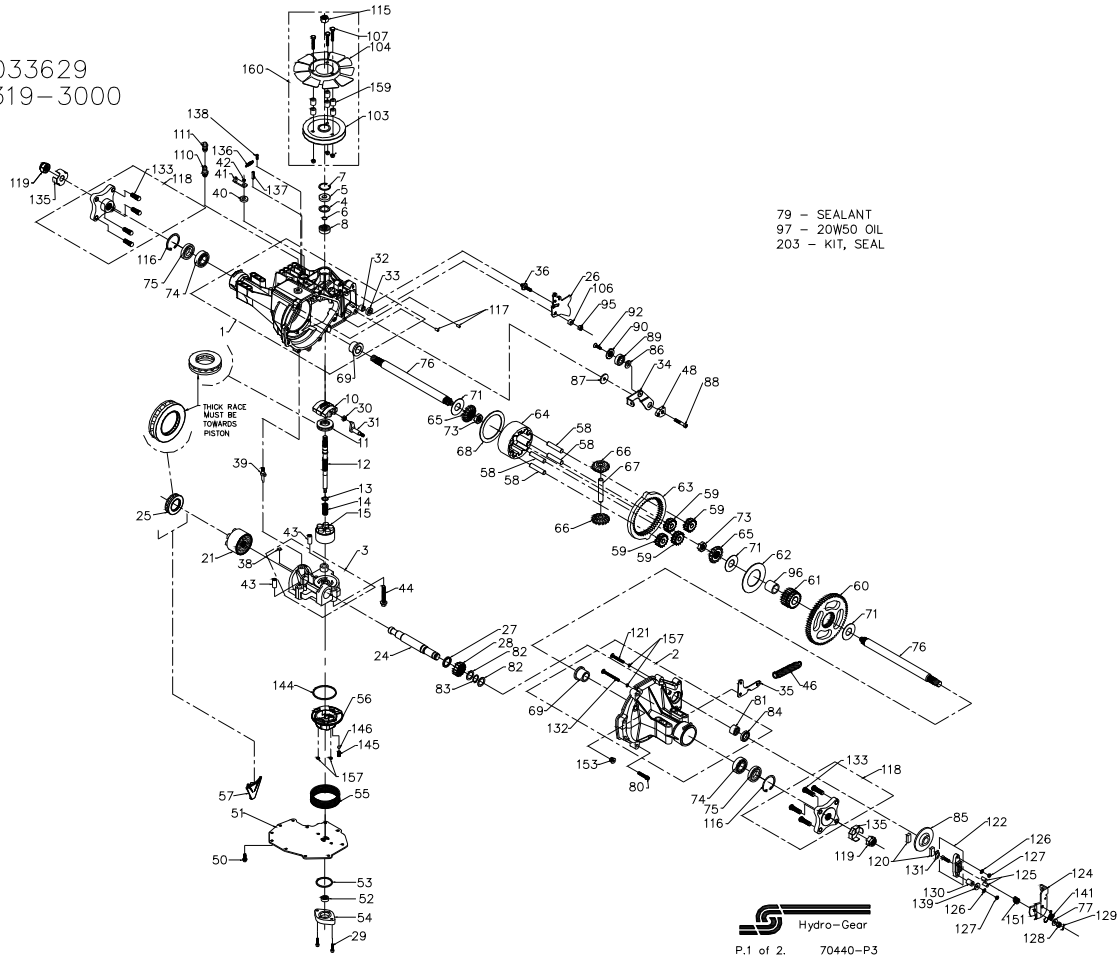

033629
319-3000

| ITEM # | PART # | QTY | DESCRIPTION | ITEM # | PART # | QTY | DESCRIPTION | ITEM # | PART # | QTY | DESCRIPTION |
|--------|--------------|-----|---------------------------------|--------|--------------|-------|---------------------------------|--------|--------------|-----|------------------------------------|
| 1 | 70297 | 1 | MAIN HOUSING ASSEMBLY | 44 | 50016 | 3 | SCREW | 118 | 70314 | 2 | HUB ASSEMBLY, 1/2-20 |
| | | 1 | MAIN HOUSING | 46 | 51199 | 1 | RETURN SPRING | | | 1 | HUB |
| | | 2 | CRADLE BEARING | 48 | 51097 | 1 | ADJUSTING PUCK | | | 4 | WHEEL STUD, 1/2-20 |
| | | 1 | LIP SEAL | 50 | 50752 | 11 | SCREW-Self TAPPING | 119 | 50863 | 2 | NUT, HEX 3/4-16 |
| | | 1 | TRUNNION BUSHING | 51 | 50972 | 1 | LOWER COVER | 120 | 44132 | 2 | PUCK, BRAKE |
| 2 | 70298 | 1 | R.H. HOUSING ASSEMBLY | 52 | 50273 | 1 | GEROTOR ASSEMBLY | 121 | 50874 | 1 | RIB NECK BOLT, 2" |
| | | 1 | R.H. HOUSING | 53 | 9004101-1340 | 1 | O-RING | 122 | 70633 | 1 | BRAKE YOKE ASSEMBLY |
| | | 1 | FLANGE BEARING | 54 | 50260 | 1 | GEROTOR COVER | 124 | 50916 | 1 | ARM, BRAKE |
| | | 2 | O RING | 55 | 70538 | 1 | KIT, FILTER | 125 | 44127 | 2 | PINS, BRAKE |
| | | 1 | RIB NECK BOLT, 2" | 56 | 51156 | 1 | CHARGE MANIFOLD | 126 | 43177 | 2 | LOCKWASHER, 1/4" |
| | | 1 | RIB NECK BOLT, 3" | 57 | 50796 | 1 | RETAINER, MOTOR BEARING | 127 | 43178 | 5 | NUT, 1/4-20 |
| | | 1 | NEEDLE BEARING (SCE1412) | 58 | 50776 | 4 | PIN, CARRIER | 128 | 44142 | 1 | NUT, CASTLE |
| | | 1 | LIP SEAL (.875I.D.x1.30.D.x.25) | 59 | 50763 | 4 | 1ST PLANET GEAR | 129 | 44101 | 1 | COITER PIN |
| 3 | 70687 | 1 | CENTER SECTION ASSEMBLY | 60 | 50646 | 1 | 67T SPUR GEAR | 130 | 23711 | 1 | SPACER |
| | | 1 | CENTER SECTION | 61 | 50645 | 1 | 21 TOOTH SUN GEAR | 131 | 44134 | 1 | PUCK PLATE |
| | | 1 | BUSHING .50X.60X.50 | 62 | 50769 | 1 | PLANET THRUST PLATE | 132 | 50865 | 1 | RIB NECK BOLT, 3" |
| | | 1 | BUSHING .90X1.02X.75 | 63 | 50764 | 1 | 51T RING GEAR | 133 | 44431 | 8 | LUG BOLT 1/2-20 |
| | | 1 | PLATE, BYPASS | 64 | 50765 | 1 | PLANETARY CARRIER | 135 | 51197 | 2 | SPINDLE CUP |
| | | 1 | CHECK PLUG ASSEMBLY, .044 | 65 | 50647 | 2 | MITER GEAR, DIFF. | 136 | 50384 | 1 | EXTENSION SPRING |
| | | 1 | CHECK PLUG ASSEMBLY, .027 | 66 | 50648 | 1 | DIFF. THRUST PLATE | 137 | 50882 | 1 | SPRING PIN |
| 4 | 2003018 | 1 | SPACER | 67 | 50766 | 1 | SHAFT, DIFFERENTIAL | 138 | 50653 | 1 | SCREW, STAP 10-32 X .5 |
| 5 | 9008000-0128 | 1 | SEAL-LIP | 68 | 50767 | 2 | FLANGE BEARING | 139 | 44278 | 1 | WASHER, 7/800 X .26SID X .125 THK |
| 6 | 2003016 | 1 | WIRE RETAINING RING | 69 | 50768 | 3 | WASHER 1.0 X 2.25 X .04 | 141 | 50884 | 1 | SPRING, BRAKE ARM BIAS |
| 7 | 2003052 | 1 | RETAINING RING | 71 | 50788 | 2 | HEX JAM NUT, 5/8-18 | 144 | 50974 | 1 | O RING, 2.987 ID 0.103 THK |
| 8 | 2003043 | 1 | BALL BEARING | 73 | 50791 | 2 | BALL BRG 6205-1 | 145 | 51157 | 1 | SPRING, RELIEF |
| 10 | 2003087 | 1 | VARIABLE SWASHPLATE | 74 | 50771 | 2 | SEAL 1"ID x 2.0472" x 0.375" | 146 | 9001214-4400 | 1 | BALL |
| 11 | 50551 | 1 | THRUST BEARING 30 X 52 X 13 | 75 | 50772 | 2 | SHAFT, AXLE | 151 | 50919 | 1 | COMP. SPRING, BRAKE ANTI-DRAG |
| 12 | 50795 | 1 | INPUT SHAFT | 76 | 50825 | 2 | WASHER | 153 | 9005110-5600 | 1 | PLUG, STRAIGHT THREAD |
| 13 | 2003017 | 1 | BLOCK THRUST WASHER | 77 | 44130 | 1 | WASHER | 157 | 50977 | 4 | O-RING, 0.070 X 0.239 |
| 14 | 2003014 | 1 | BLOCK SPRING | 79 | 50928 | 1 | SEALANT | 159 | 50259 | 6 | SPACER |
| 15 | 70331 | 1 | 10cc CYLINDER BLOCK ASSEMBLY | 80 | 50868 | 9 | TORX HEAD SCREW, 5/16-18 | 160 | 70488 | 1 | FAN/PULLEY ASS'Y KIT |
| | | 1 | 10cc CYLINDER BLOCK | 81 | 44752 | 1 | NEEDLE BEARING (SCE1412) | | | 1 | PULLEY |
| | | 5 | 10cc PISTON | 82 | 50777 | 2 | WASHER | | | 3 | SCREW 1/4-20 X 2 |
| | | 5 | 10cc PISTON SPRING | 83 | 50775 | 1 | RETAINING RING | | | 1 | JAM NUT |
| | | 5 | PISTON SEAT WASHER | 84 | 50773 | 1 | LIP SEAL (.875I.D.x1.30.D.x.25) | | | 3 | NUT, 1/4-20 |
| 21 | 70082 | 1 | 21cc CYLINDER BLOCK ASSEMBLY | 85 | 50779 | 1 | WASHER .5 X 1.0 X .03 | | | 6 | SPACER |
| | | 1 | 21cc CYLINDER BLOCK | 86 | 50132 | 1 | WASHER | | | 1 | KIT, SEAL |
| | | 7 | PISTON SEAT WASHER | 87 | 50836 | 1 | CAPSCREW, 5/16-24X1.5 | | | 1 | SEAL-LIP |
| | | 7 | 21cc PISTON | 88 | 50837 | 1 | BEARING | | | 1 | SEAL-LIP |
| | | 7 | 21cc PISTON SPRING | 89 | 44147 | 1 | SPACER, LOCATING | | | 1 | O-RING |
| 24 | 50662 | 1 | OUTPUT (MOTOR) SHAFT | 90 | 51200 | 1 | COUNTERSUNK SCREW | | | 2 | SEAL 1" ID X 2.0472" X .375" |
| 25 | 50652 | 1 | THRUST BEARING 42 X 68 X 16 | 92 | 50870 | 1 | HEX LOCK NUT 5/16-24 | | | 1 | LIP SEAL (.875 I.D.X1.3 O.D. X.25) |
| 26 | 51250 | 1 | CONTROL ARM | 95 | 50108 | 1 | SLEEVE BEARING | | | 2 | O-RING, 070X.239 |
| 27 | 50774 | 1 | SPACER | 96 | 50866 | 1 | 20W-50 OIL | | | 2 | SCREW O-RING |
| 28 | 50661 | 1 | 16T PINION GEAR | 97 | | 122oz | PULLEY | | | 1 | KIT, O-RING, MANIFOLD |
| 29 | 50975 | 2 | CAPSCREW, M6 X 1-25 | 103 | 50302 | 1 | FAN | | | | |
| 30 | 2003015 | 1 | SLOT GUIDE | 104 | 50307 | 1 | SPACER, TRUNNION | | | | |
| 31 | 50807 | 1 | TRUNNION ARM | 106 | 50850 | 1 | RETAINING RING | | | | |
| 32 | 2003009 | 1 | TRUNNION BUSHING | 107 | 44300 | 3 | SCREW 1/4-20 X 2 | | | | |
| 33 | 9008000-0126 | 1 | LIP SEAL | 110 | 70110 | 1 | FITTING-O RING ASS'Y | | | | |
| 34 | 51127 | 1 | RETURN ARM | | | 1 | PLASTIC HOSE FITTING | | | | |
| 35 | 51183 | 1 | BRACKET, DAMPER | 111 | 70109 | 1 | O-RING | | | | |
| 36 | 50426 | 1 | 5/16-24 STUD | | | 1 | CAP VENT ASS'Y | | | | |
| 38 | 70680 | 1 | KIT, BYPASS PLATE | | | 1 | PLASTIC VENT | | | | |
| 39 | 2003555 | 1 | BYPASS ACTUATOR | | | 1 | CAP-VENT | | | | |
| 40 | 45074 | 1 | LIP SEAL | 115 | 44133 | 1 | JAM NUT | | | | |
| 41 | 50270 | 1 | BYPASS ARM | 116 | 50859 | 2 | RETAINING RING | | | | |
| 42 | 44870 | 1 | RETAINING RING | 117 | 9004800-2506 | 2 | STD HDLS PIN | | | | |
| 43 | 50002 | 2 | PIN | | | | | | | | |